

NOTICE DE MONTAGE
INSTRUCTIONS FOR ASSEMBLY
MONTAGEANLEITUNG
GEBRUIKSAANWIJZING
ISTRUZIONI DI MONTAGGIO
INSTRUCCIONES DE MONTAJE
INSTRUÇÕES DE MONTAGEM

buronomic
FABRICANT FRANÇAIS

N° DV40826/04

CONCEPTION ET REALISATION BUREAU D'ETUDES BURONOMIC

GARANTIE (vices cachés)
Référence produit à nous communiquer impérativement en cas de litige :
Voir étiquette apposée au dos du produit

GARANTIE (defekt)
In the event of complaint, it is essential to mention the product reference :
See label affixed to the back of the product.

GARANTIE (fabrikationsfehler)
Im streifall sit uns die produktreferenz mitzuteilen :
Siehe etikett auf produktseite.

WAARBORG (de verborgen gebreken)
Vermeld in geval van klachten altijd het productnummer :
Zie label op de achterzijde van het product

GARANZIA (vizi occulti)
Specificare obbligatoriamente il riferimento prodotto in caso di contestazioni :
Si veda l'etichetta applicata dietro il prodotto

GARANTIA (defectos ocultos)
Referencia de producto citese obligatoriamente en caso de reclamacion :
Ver etiqueta en la parte posterior del producto.

GARANTIA (vices ocultos)
Em caso de reclamacao indiqu-nos imperativamente a referencia do produto :
Ver etiqueta fixada na parte posterior do produto

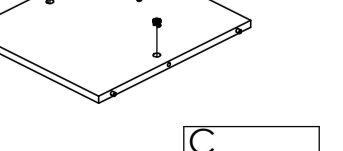
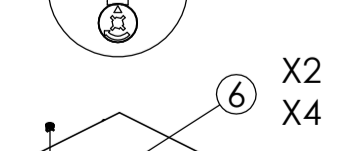
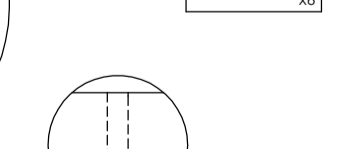
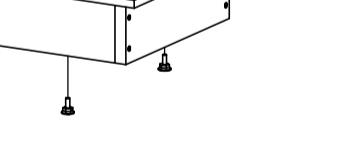
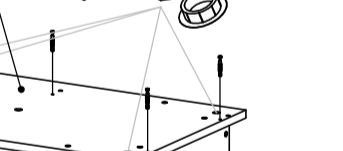
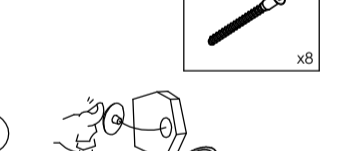
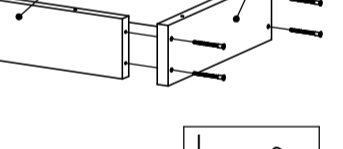
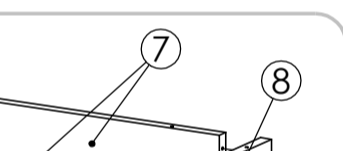
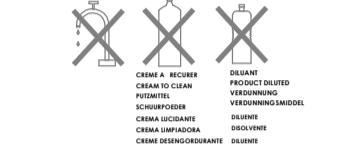
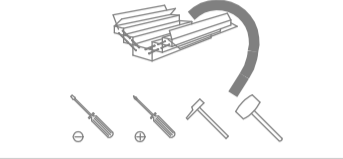
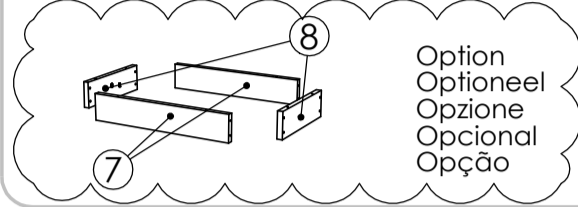
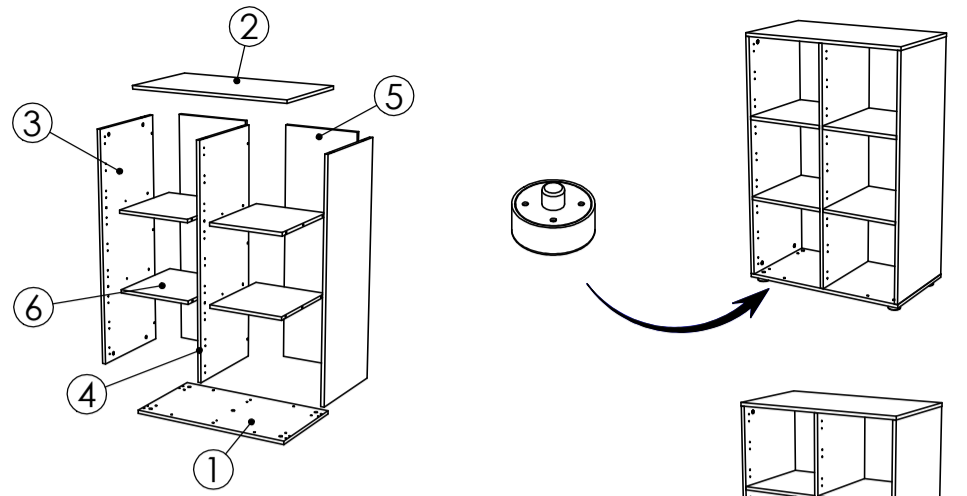

NOMENCLATURE (Parts list)
(Stückliste)
(Onderdelenlijst)
(Nomenclatura)
(Lista de peças)

Rep.	Pièce	Qté
1	FOND	1
2	DESSUS	1
3	COTE	2
4	SEPARATION	1
5	PAR	2
6	TABLETTE FIXE	2/4

Rep.	Pièce	Qté
7	SOCLE FRONTAL	2
8	SOCLE LATERAL	2

QUINCAILLERIE (Hardware)
(Beschläge)
(Ijzerwaren)
(Ferramenta)
(Herrajes)
(Quinquilharia)

Rep.	Pièce	Qté	Qté
A	Patin HT 23	5	5
B	Vis TF 3,5x13	10	10
C	Excentrique court	16	20
D	Goujon bois	14	16
E	Goujon bois 7,5 mm	2	4
F	Cache excent.	16	20
G	Cache Ø8	8	8
H	Cache Ø15	4	4
I	Clé 6 pans 4mm	1	1
N	Vis relieuse	2	-
O	Vis TRL 4x15	2	-
J	Vis 7x70	8	
K	Vis 7x50	8	
L	Cache vis	16	
M	Vérin Standard	4	

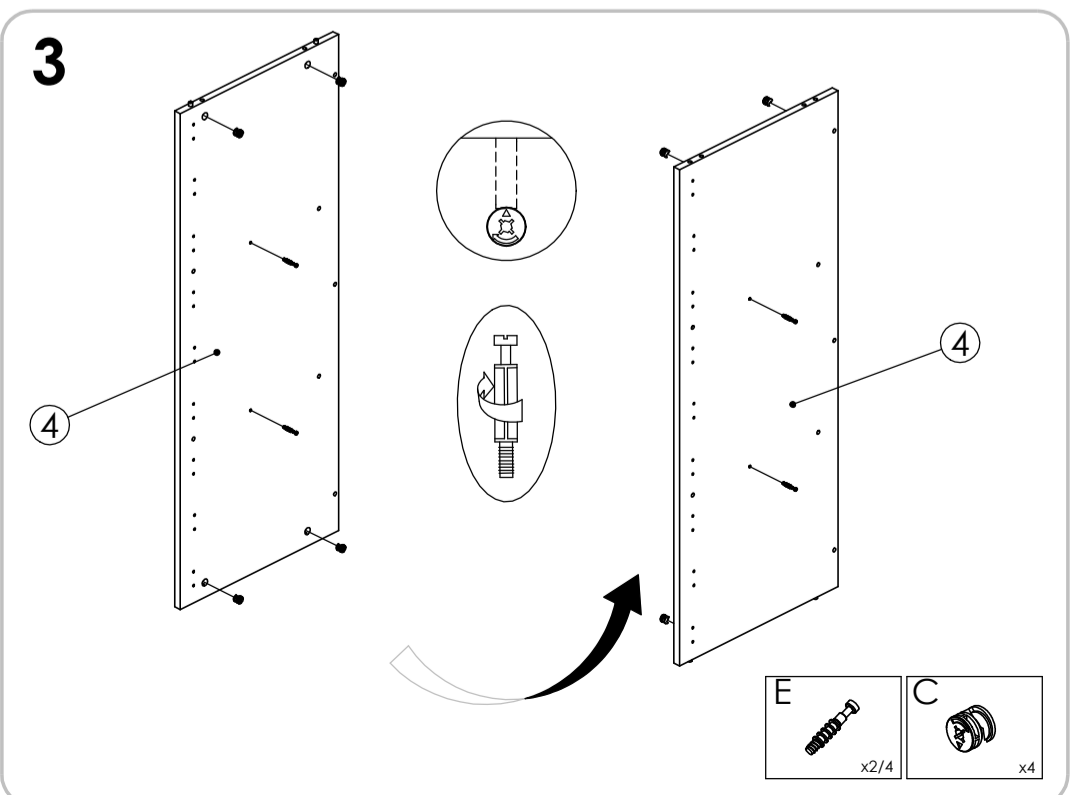
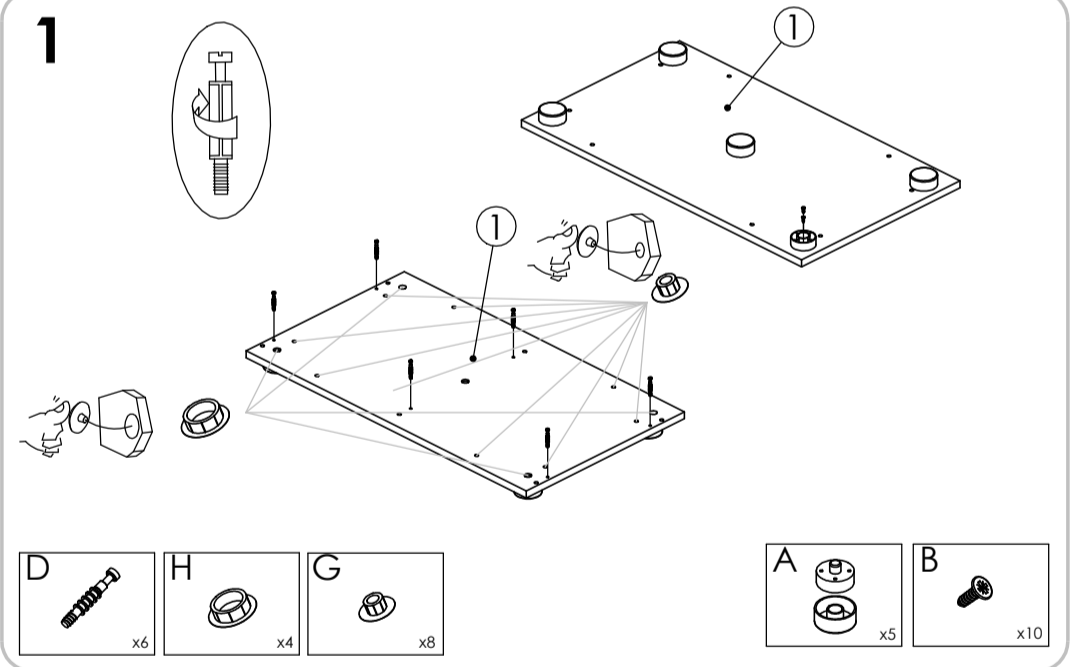
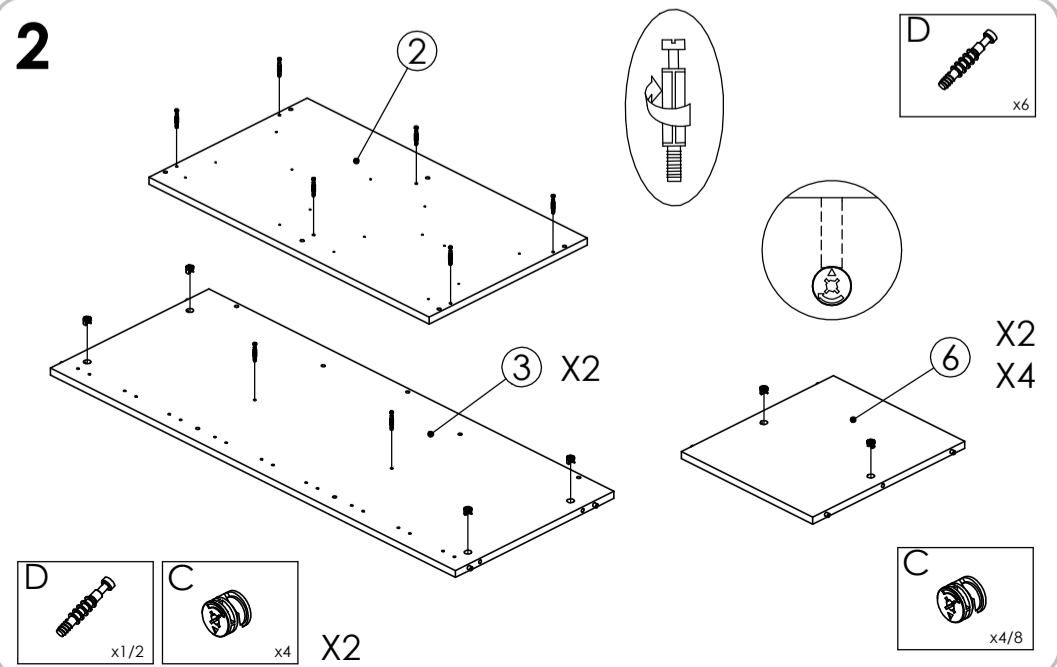
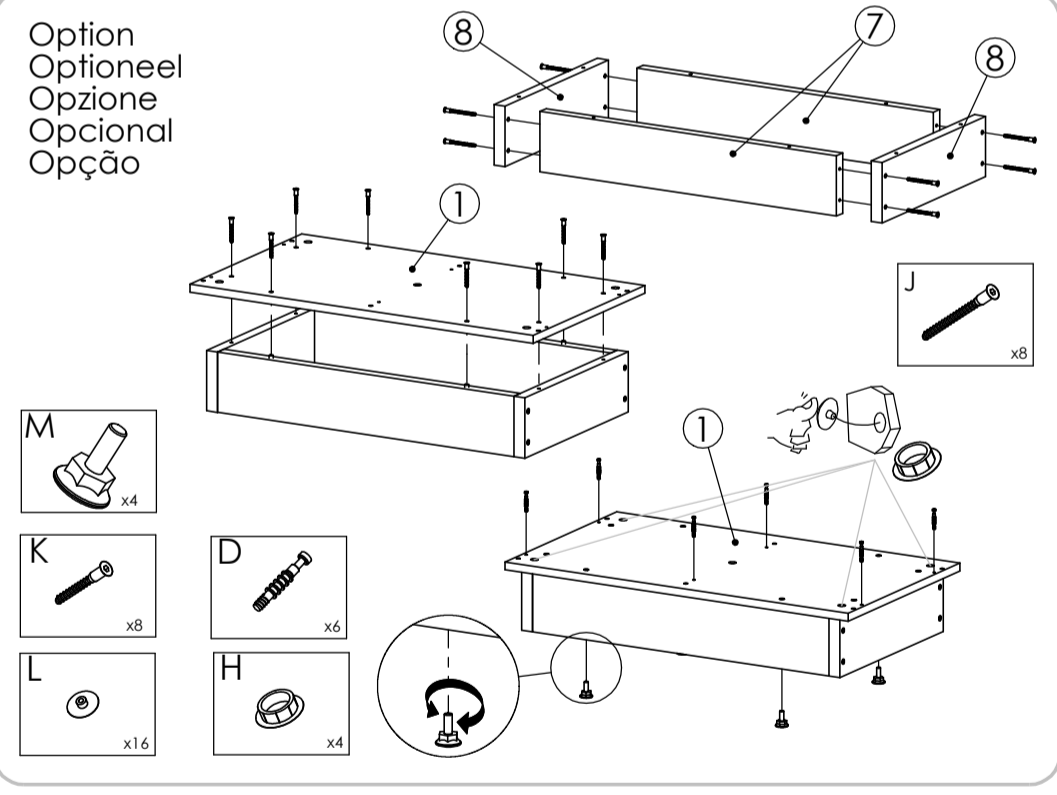
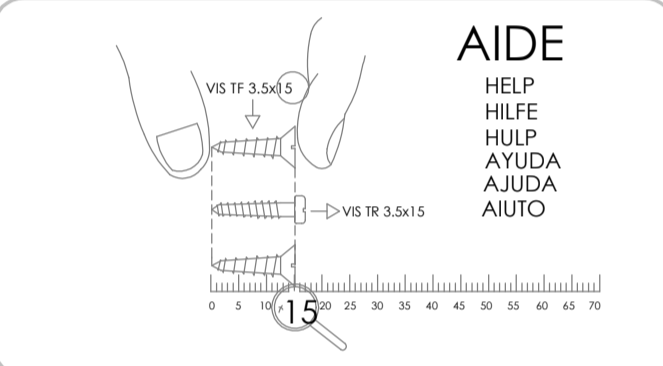
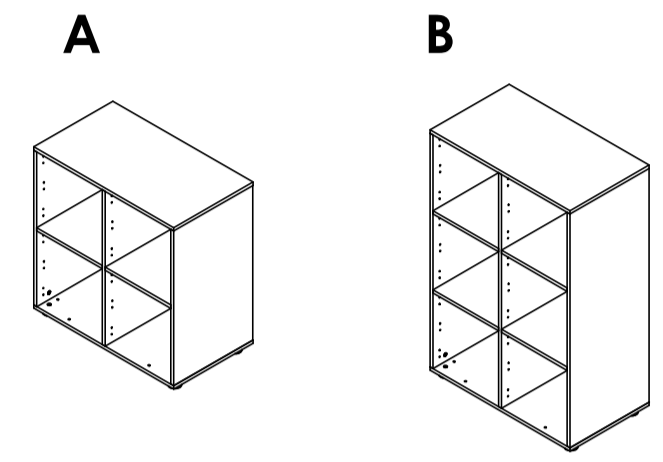

4

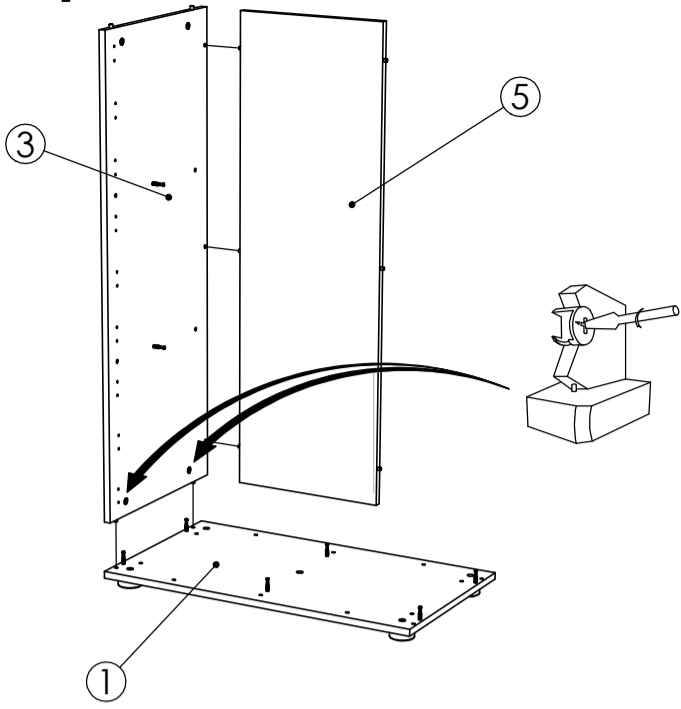

5

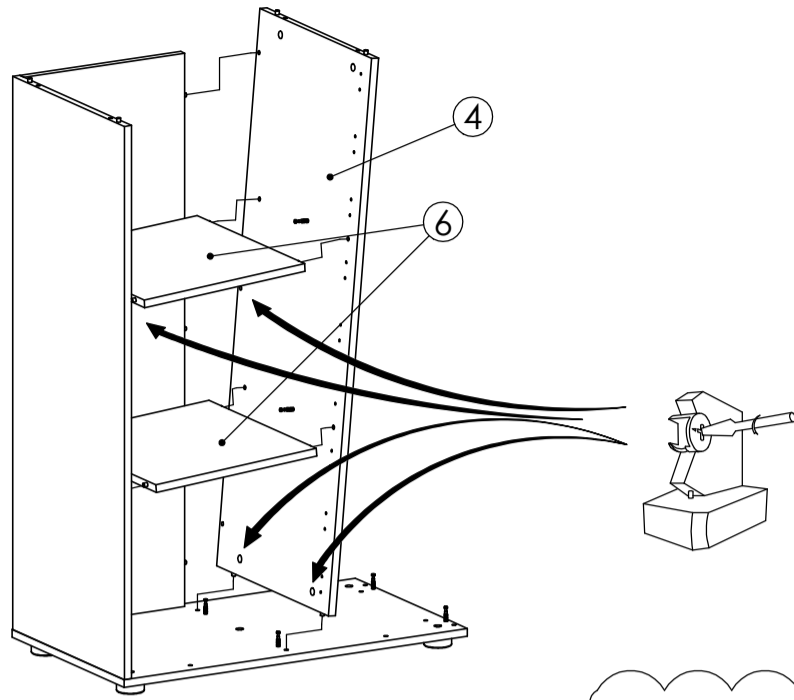

6

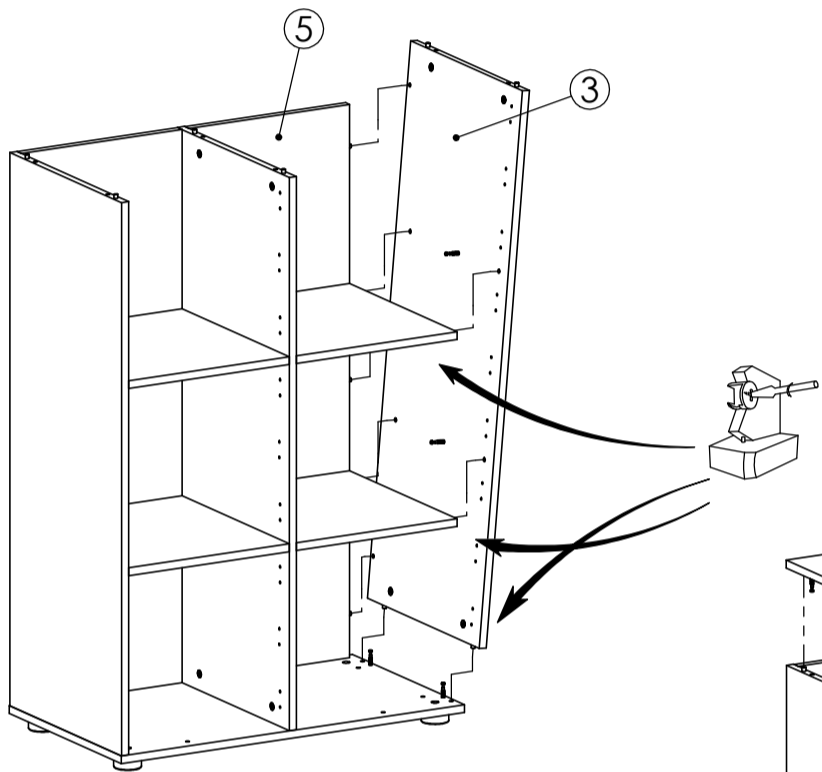

7

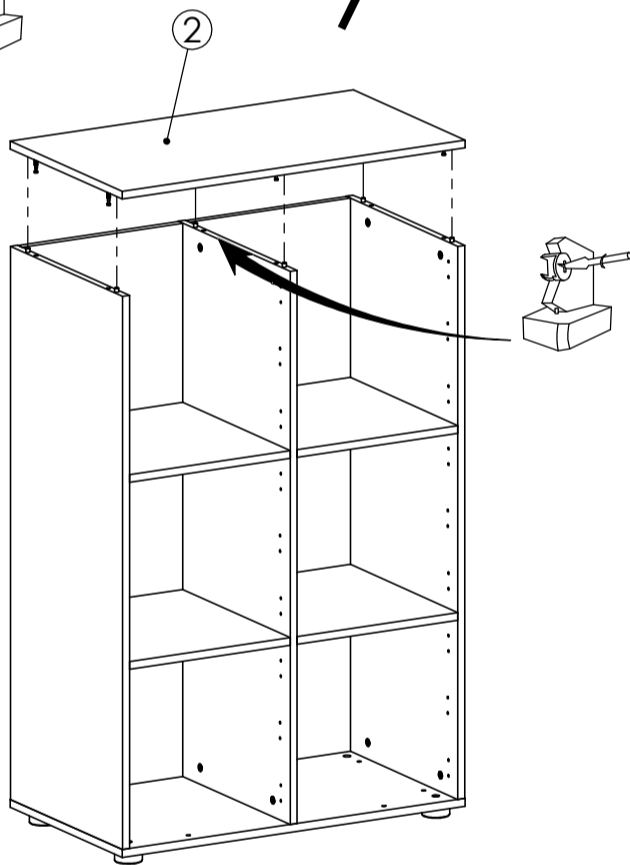

8

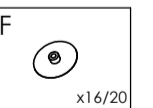
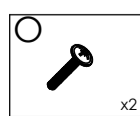
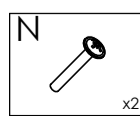
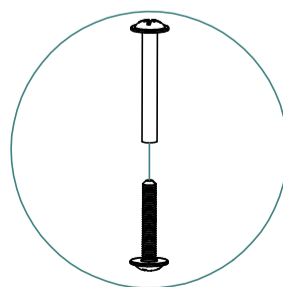
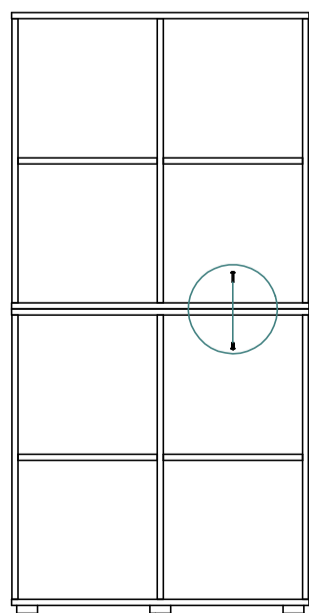
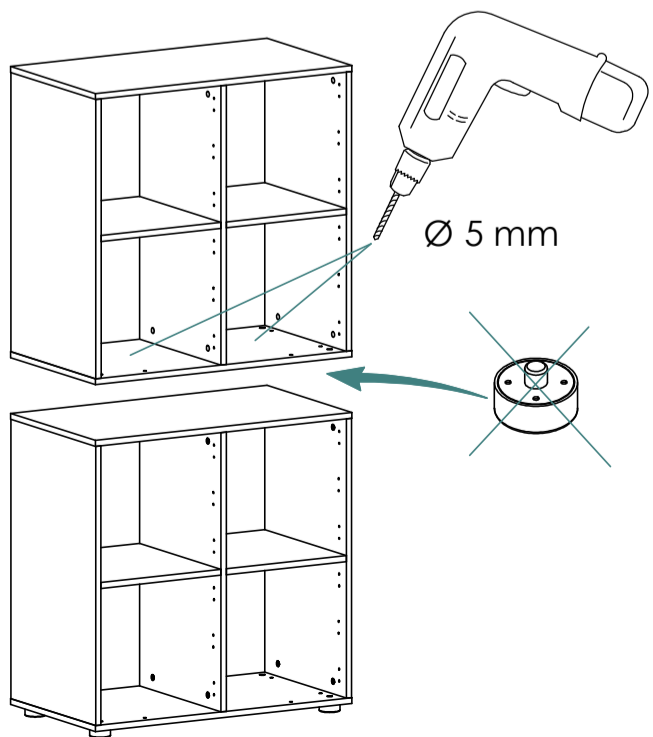
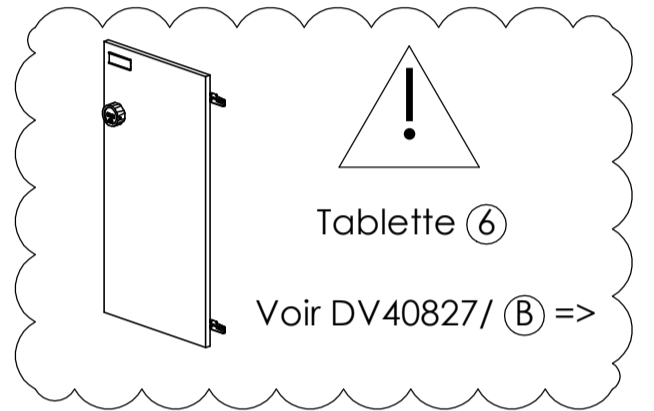
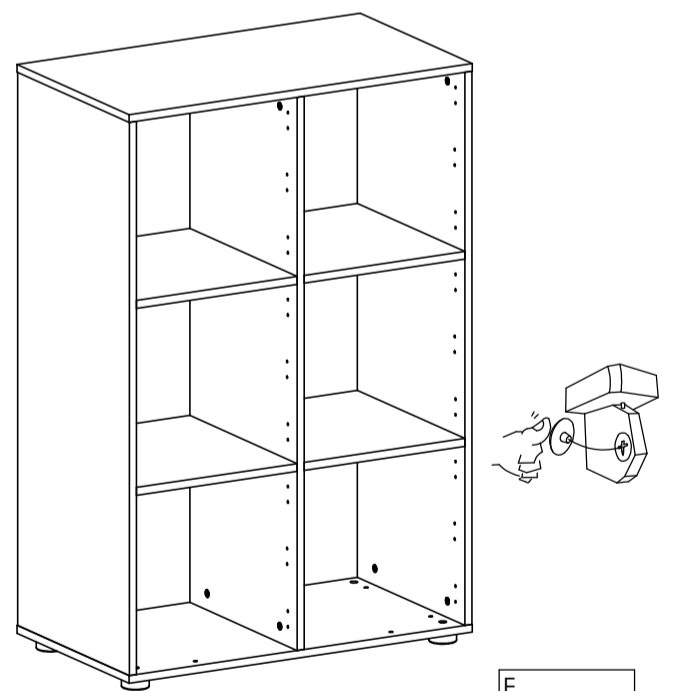

NOTICE DE MONTAGE
INSTRUCTIONS FOR ASSEMBLY
MONTAGEANLEITUNG
GEBRUIKSAANWIJZING
ISTRUZIONI DI MONTAGGIO
INSTRUCCIONES DE MONTAJE
INSTRUÇÕES DE MONTAGEM

buronomic
FABRICANT FRANÇAIS

N° DV40792/04

CONCEPTION ET REALISATION BUREAU D'ETUDES BURONOMIC

GARANTIE (vices cachés)
Référence produit à nous communiquer impérativement en cas de litige :
Voir étiquette apposée au dos du produit

GARANTEE (defekt)
In the event of complaint, it is essential to mention the product reference :
See label affixed to the back of the product.

GARANTIE (fabrikationsfeil)
Im streifall sit uns die produktreferenz mitzuteilen :
Siehe etikett auf produktseite.

WAARBORG (de verborgen gebreken)
Vermeld in geval van klachten altijd het productnummer :
Zie label op de achterzijde van het product

GARANZIA (vizi occulti)
Specificare obbligatoriamente il riferimento prodotto in caso di contestazioni :
Si veda l'etichetta applicata dietro il prodotto

GARANTIA (defectos ocultos)
Referencia de producto citese obligatoriamente en caso de reclamacion :
Ver etiqueta en la parte posterior del producto.

GARANTIA (vices ocultas)
Em caso de reclamacao indiqu-nos imperativamente a referencia do produto :
Ver etiqueta fixada na parte posterior do produto

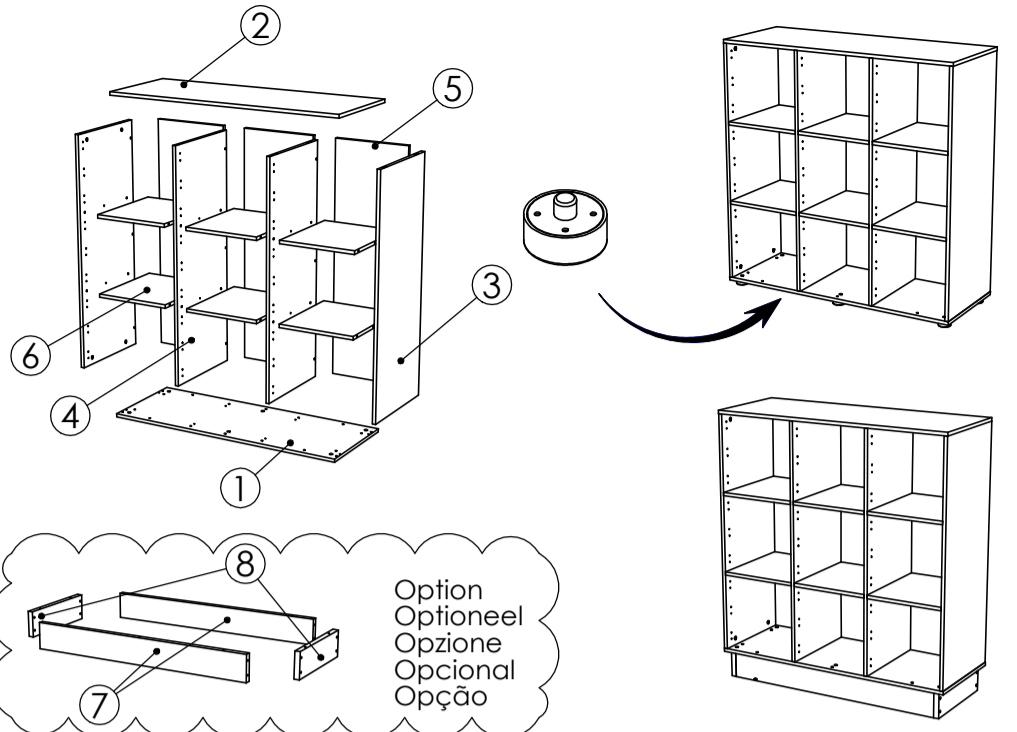

Option
Optioneel
Opzione
Opcional
Opção

A

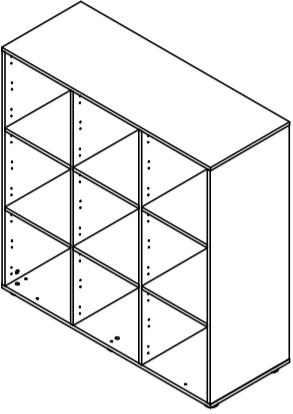

B

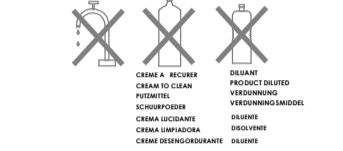
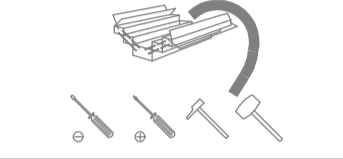
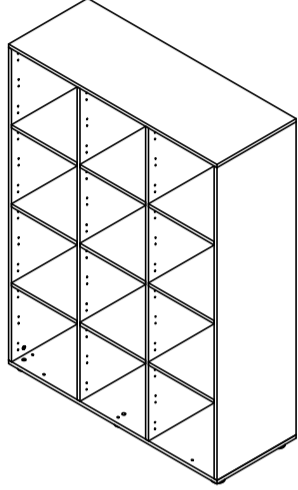

NOMENCLATURE

(Parts list)
(Stückliste)
(Onderdelenlijst)
(Nomenclatura)
(Lista de peças)

Rep.	Pièce	Qté
1	FOND	1
2	DESSUS	1
3	COTE	2
4	SEPARATION	2
5	PAR	3
6	TABLETTE FIXE	6/9

Rep.	Pièce	Qté
7	SOCLE FRONTAL	2
8	SOCLE LATERAL	2

QUINCAILLERIE

A B

(Hardware)
(Beschläge)
(Ijzerwaren)
(Ferramentas)
(Herrajes)
(Quinquilharia)

Rep.	Pièce	Qté	Qté
A	Patin Ht 23	6	6
B	Vis TF 3.5x13	12	12
C	Excentrique Ø15	28	34
D	Goujon bois	20	22
E	Goujon bois 7.5 mm	8	12
F	Cache excent.	28	34
G	Cache Ø8	10	10
H	Cache Ø15	6	6
I	Clé 6 pans 4mm	1	1
J	Vis 7x70	8	
K	Vis 7x50	10	
L	Cache vis	18	
M	Vérin Standard	4	

AIDE

HELP
HILFE
HULP
AYUDA
AJUDA
AIUTO

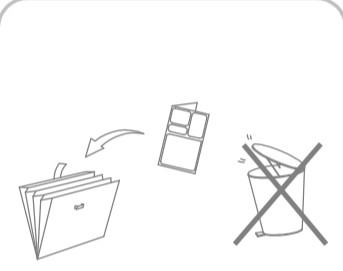
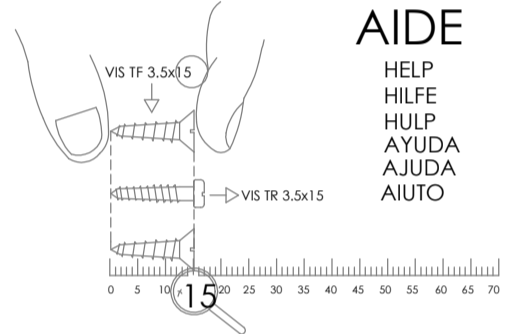

Option
Optioneel
Opzione
Opcional
Opção

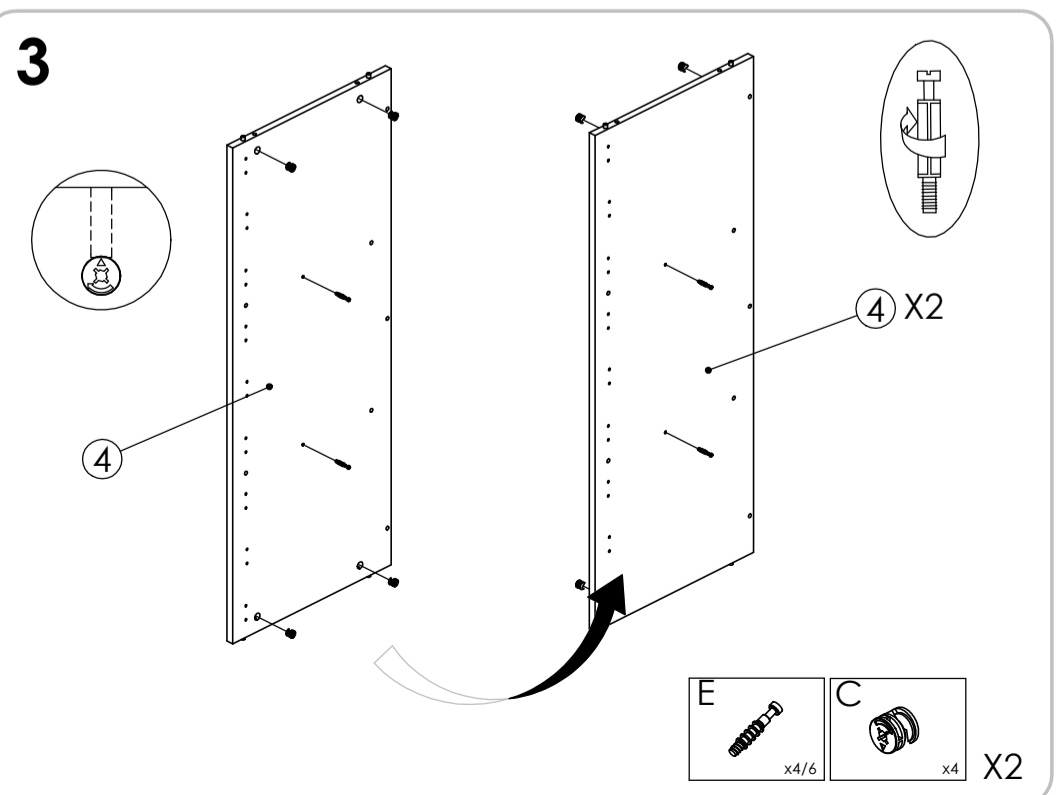
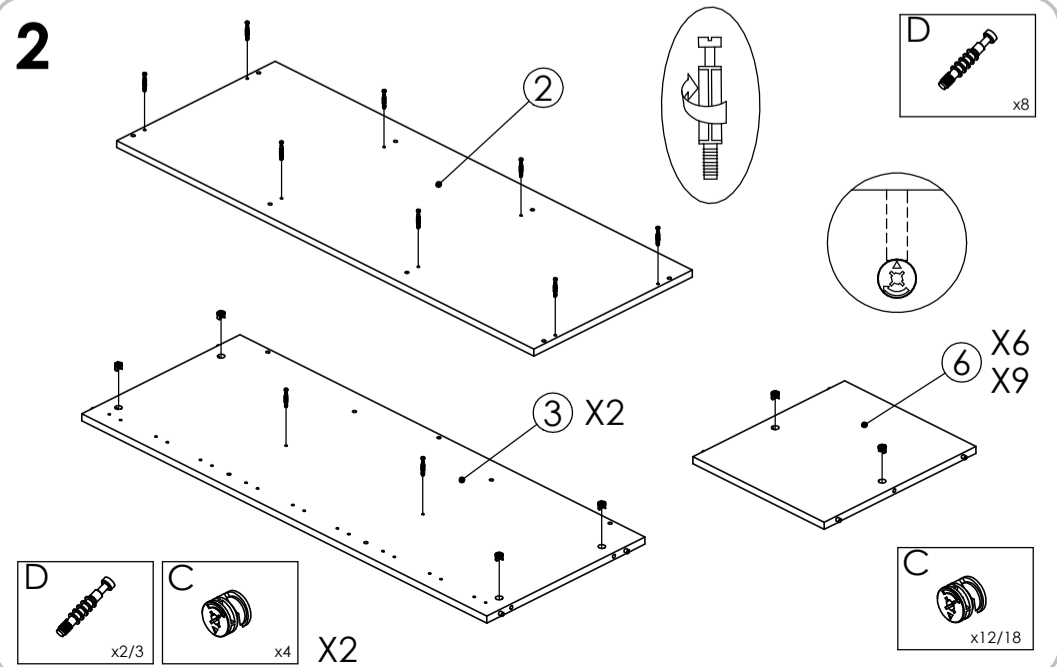
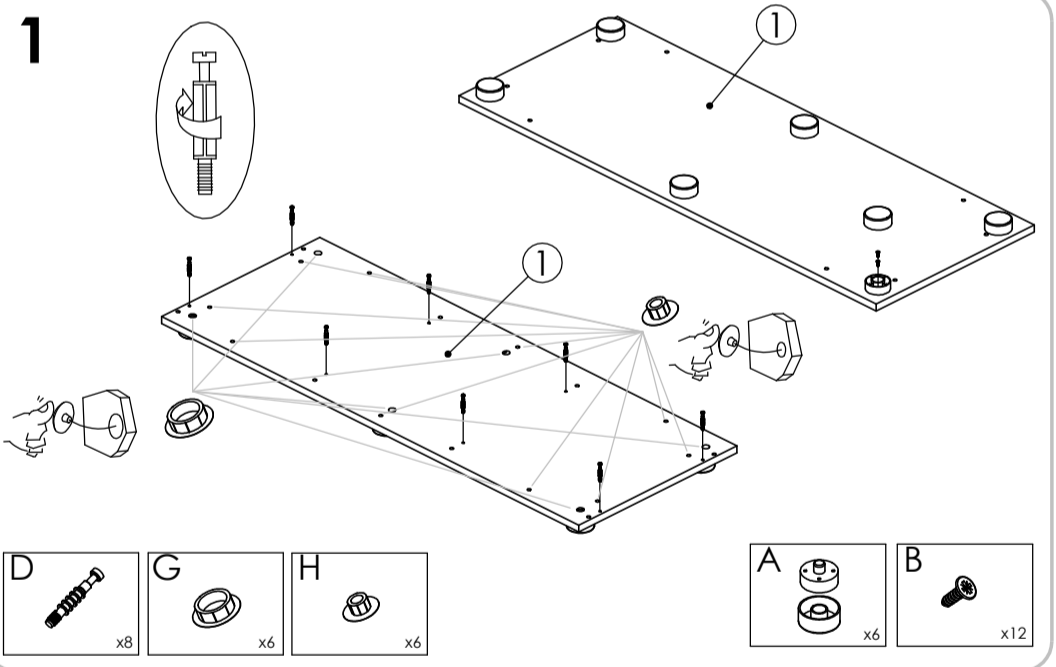
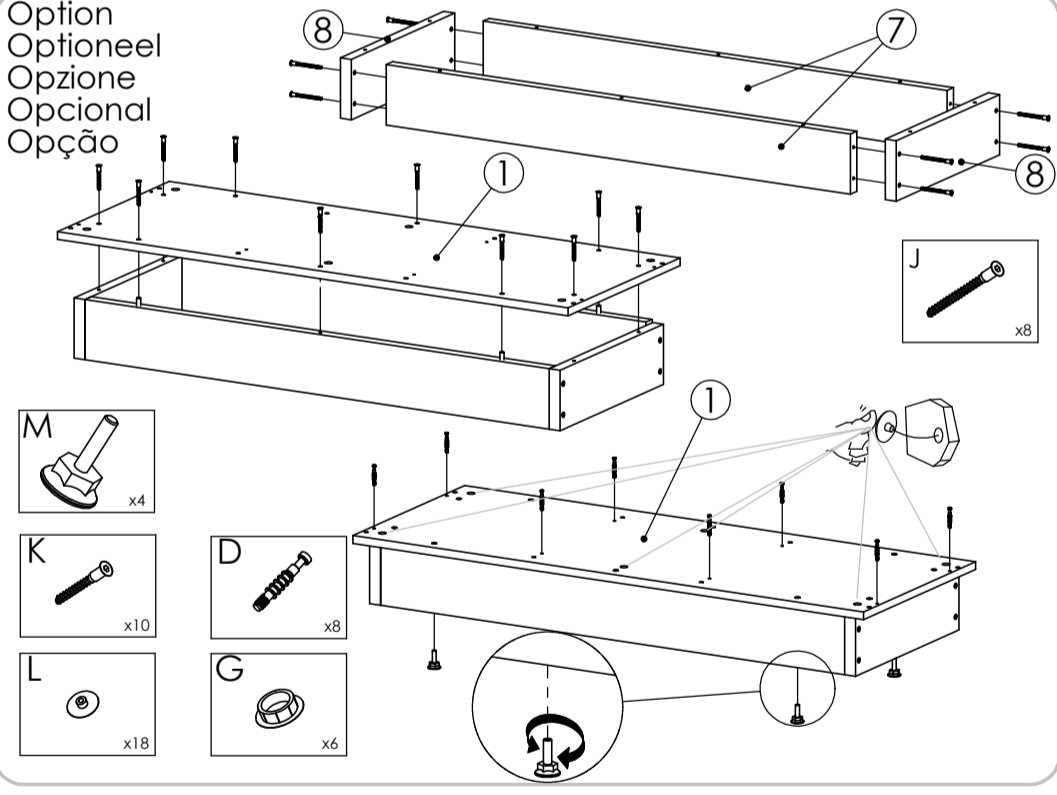

4

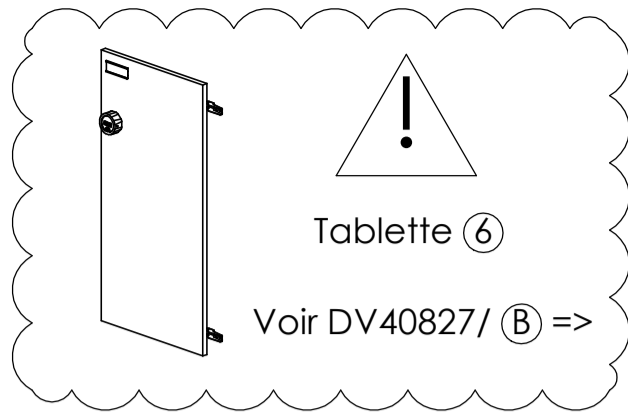
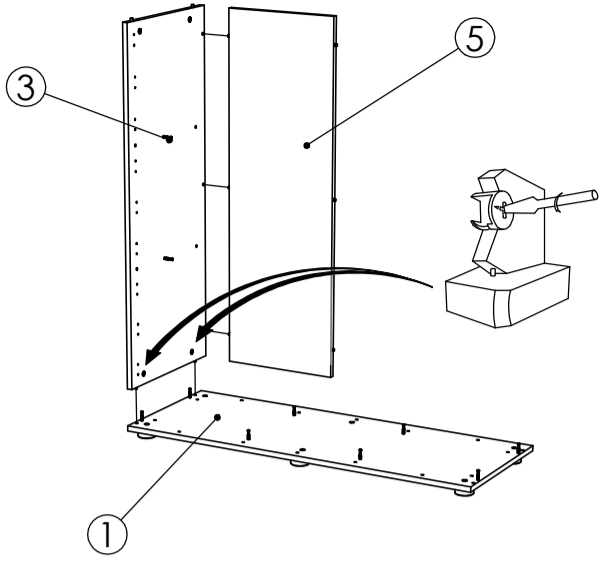

5

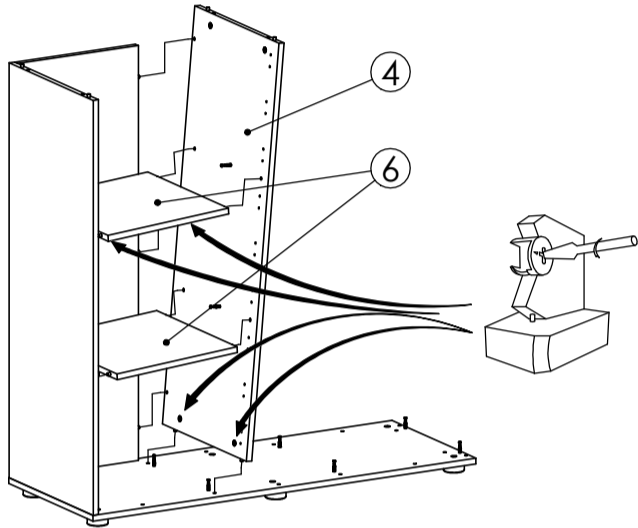

6

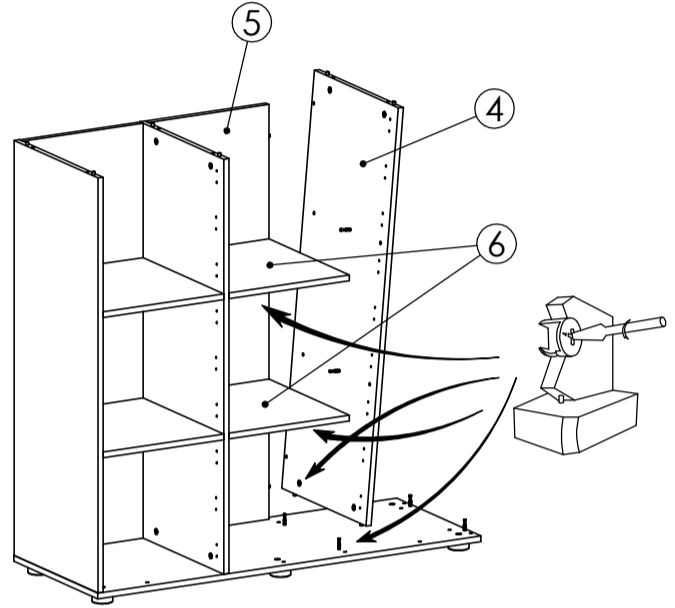

7

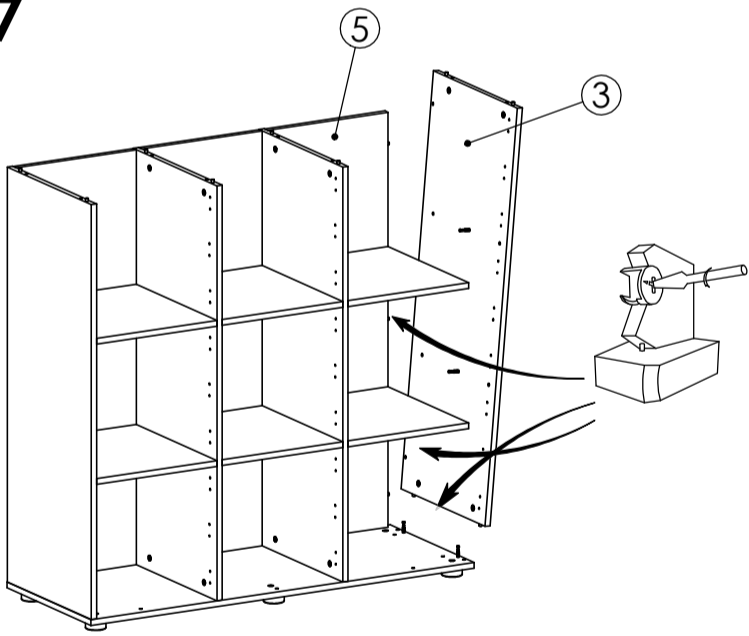

8

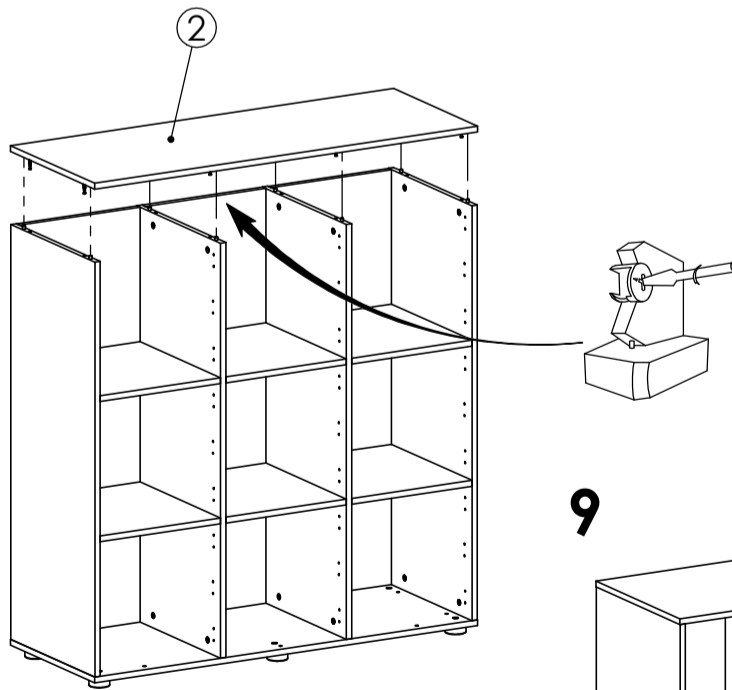

9

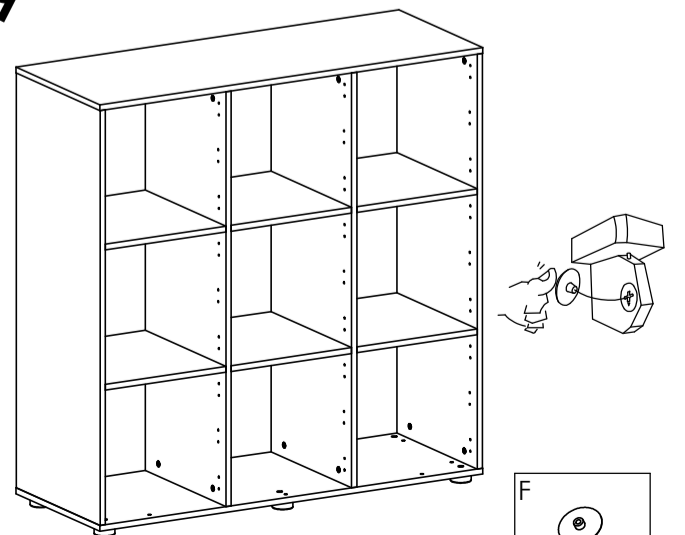

NOTICE DE MONTAGE
INSTRUCTIONS FOR ASSEMBLY
MONTAGEANLEITUNG
GEBRUIKSAANWIJZING
ISTRUZIONI DI MONTAGGIO
INSTRUCCIONES DE MONTAJE
INSTRUÇÕES DE MONTAGEM

buronomic
FABRICANT FRANÇAIS

N° DV40956

CONCEPTION ET REALISATION BUREAU D'ETUDES BURONOMIC

GARANTIE (vices cachés)
_ Référence produit à nous communiquer impérativement en cas de litige :
Voir étiquette apposée au dos du produit

GARANTIE (defekt)
_ In the event of complaint, it is essential to mention the product reference :
See label affixed to the back of the product.

GARANTIE (fabrikationsfehler)
_ Im streifall sit uns die produktreferenz mitzuteilen :
Siehe etikett auf produkruckseite.

WAARBORG (de verborgen gebreken)
_ Vermeld in geval van klachten altijd het productnummer :
Zie label op de achterzijde van het product

GARANZIA (vizi occulti)
_ Specificare obbligatoriamente il riferimento prodotto in caso di contestazioni :
Si veda l'etichetta applicata dietro il prodotto

GARANTIA (defectos ocultos)
_ Referencia de producto citese obligatoriamente en caso de reclamacion :
Ver etiqueta en la parte posterior del producto.

GARANTIA (vices ocultos)
_ Em caso de reclamacao indiqu-nos imperativamente a referencia do produto :
Ver etiqueta fixada na parte posterior do produto

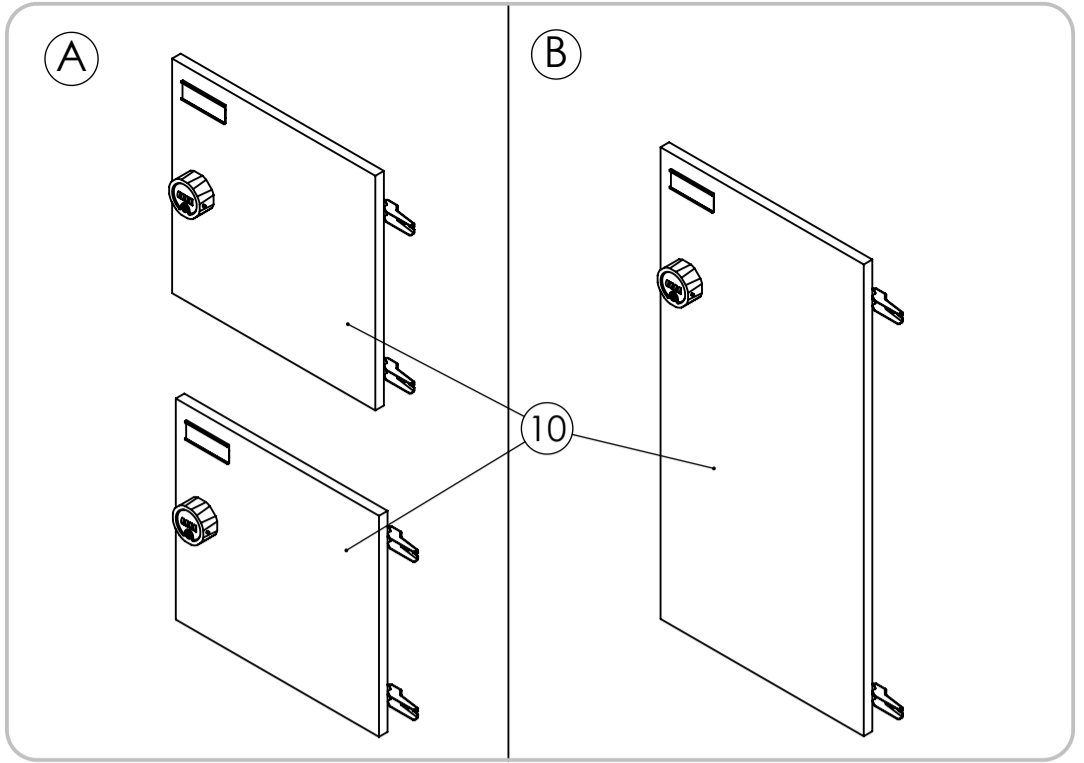
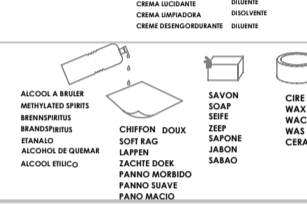
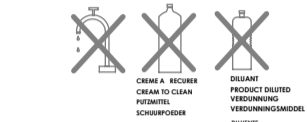
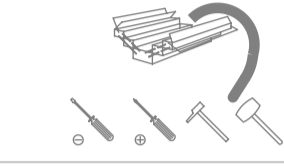
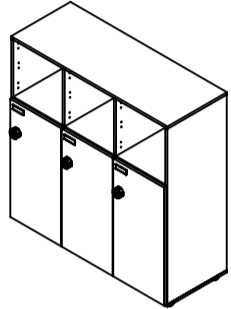
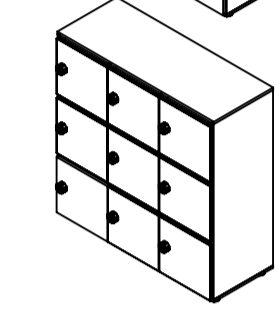
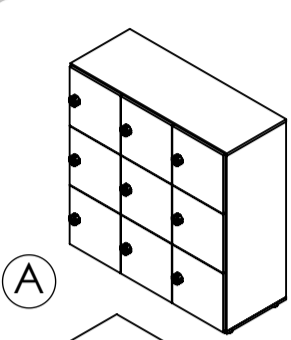

NOMENCLATURE (Parts list)
(Stückliste)
(Onderdelenlijst)
(Nomenclatura)
(Lista de peças)

Rep.	Pièce	Qté
10	PORTE serrure à code	1

QUINCAILLERIE (Hardware)
(Beschläge)
(Izerwaren)
(Ferramentas)
(Quinilharia)

Rep.	Pièce	Qté	M	N	O
M	Serrure code privée DOM RONIS	3			
N	GACHE Tôle	3			
O	VIS Euro L 13mm	6			
P	Vis TCB 3x13	3			
Q	Charnière	6			
R	Cale charnière	6			
S	Porte étiquette	3			

AIDE

HELP
HILFE
HULP
AYUDA
AJUDA
AIUTO

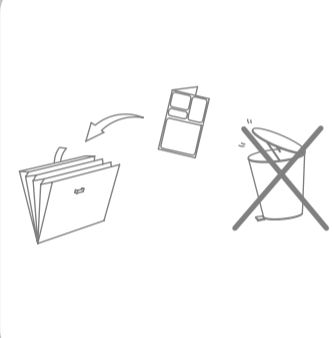
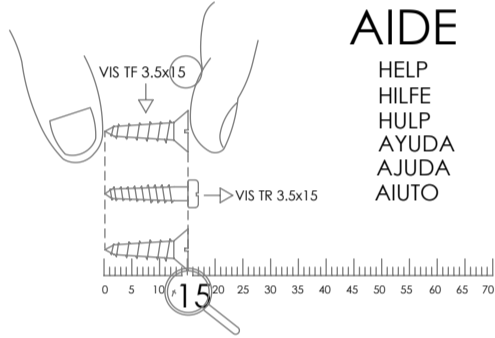

1A

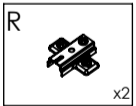
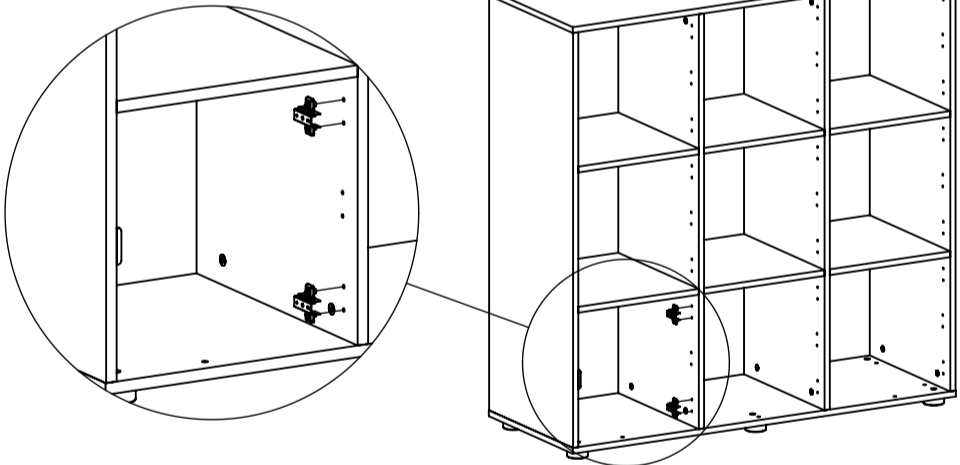

1B

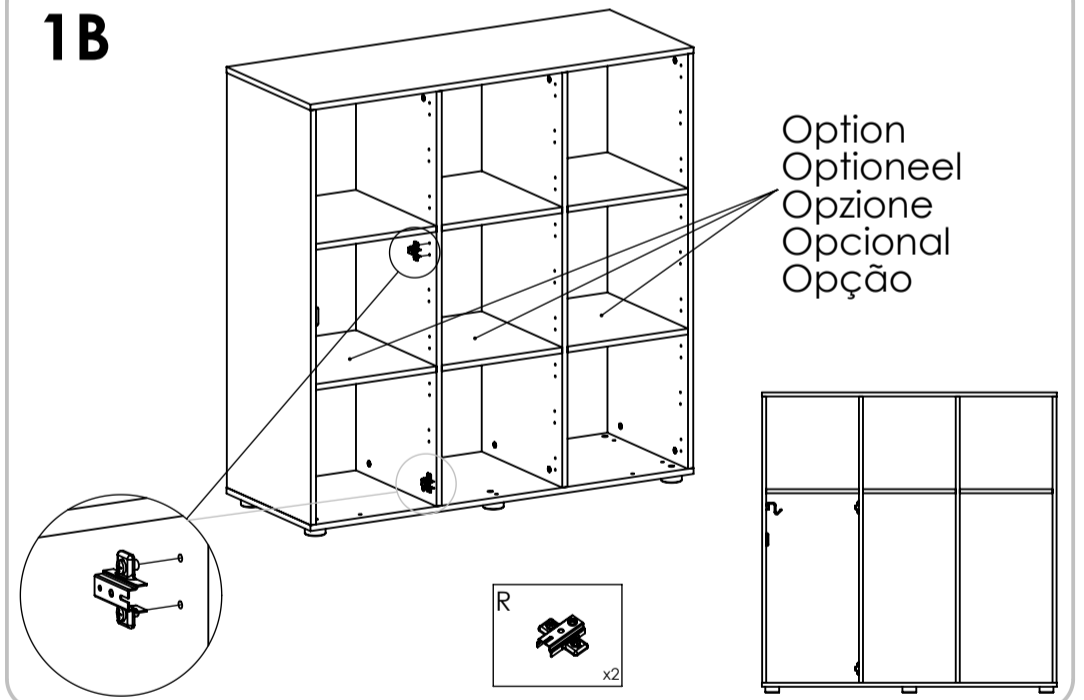

Option
Optioneel
Opzione
Opcional
Opção

2A

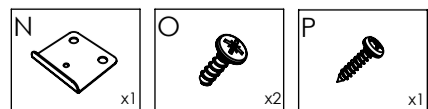
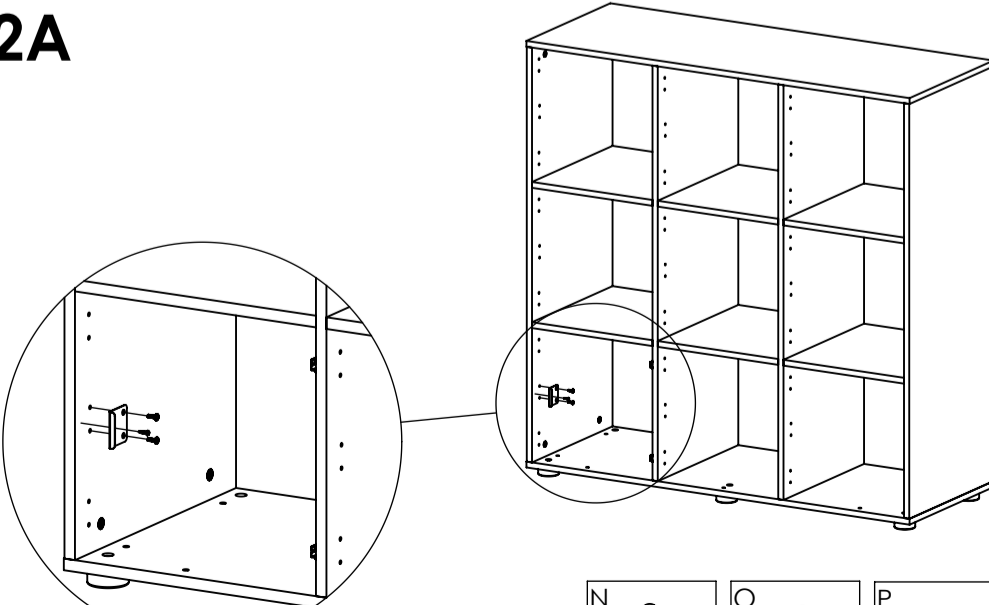

2B

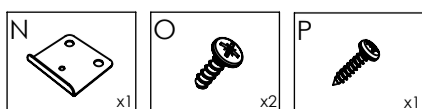
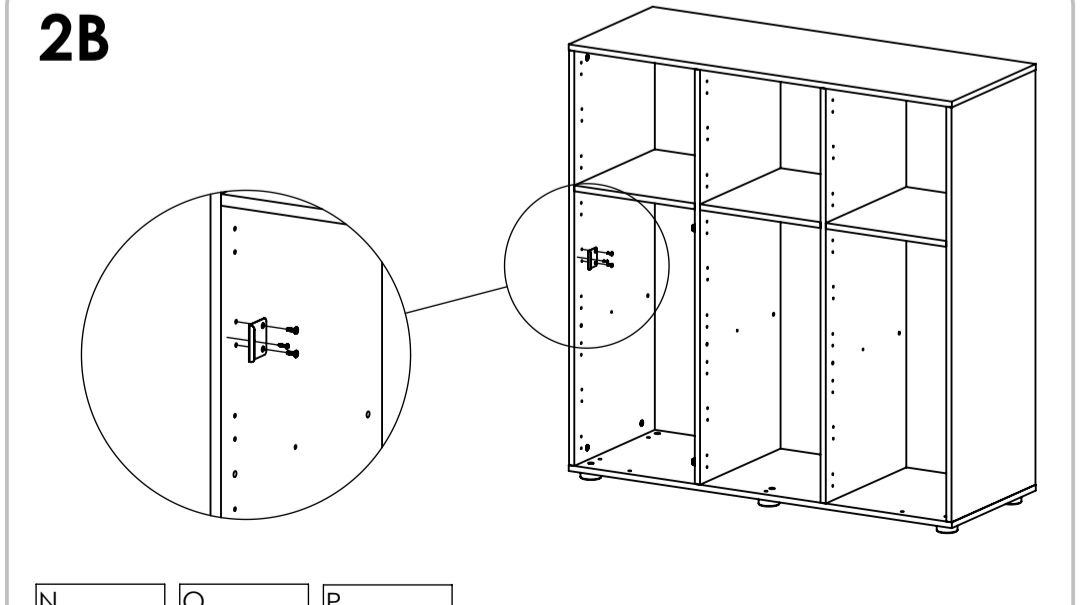

3A

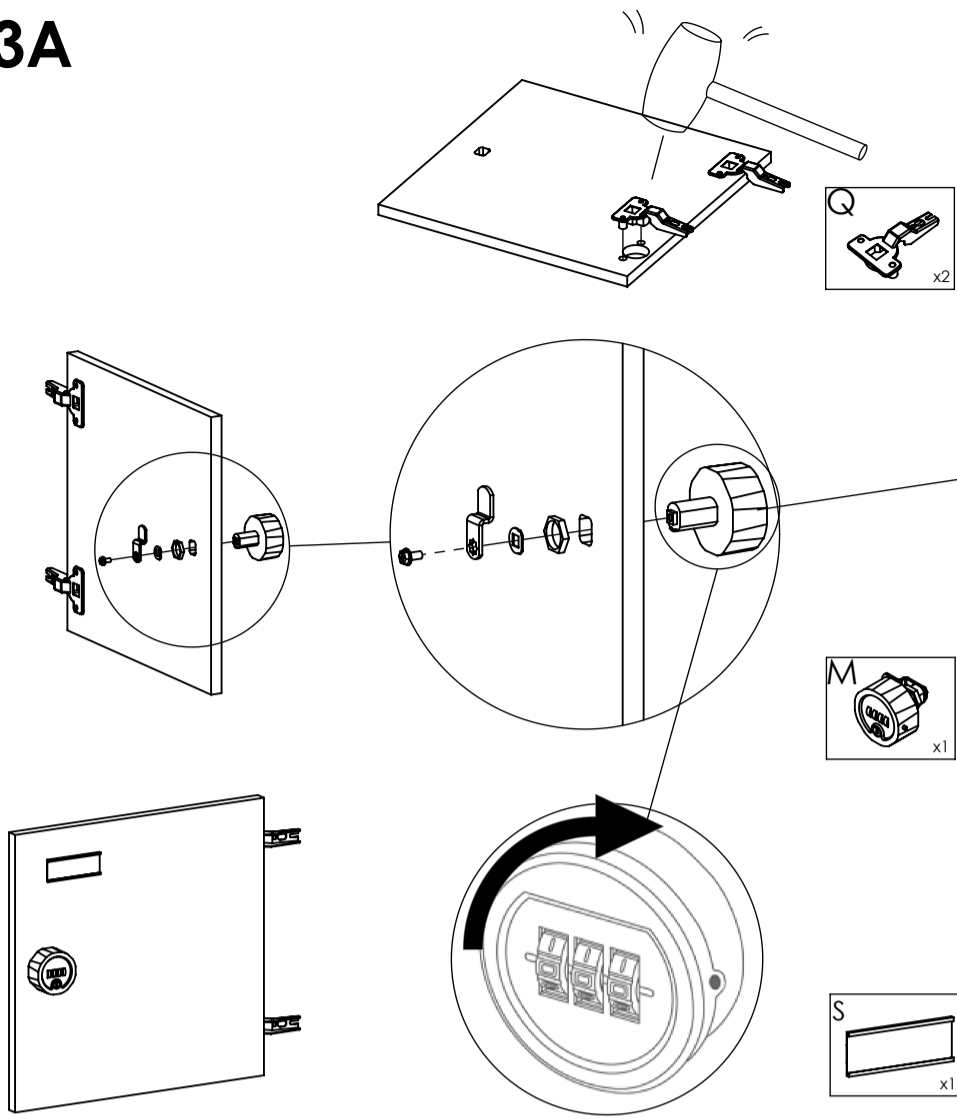

3B

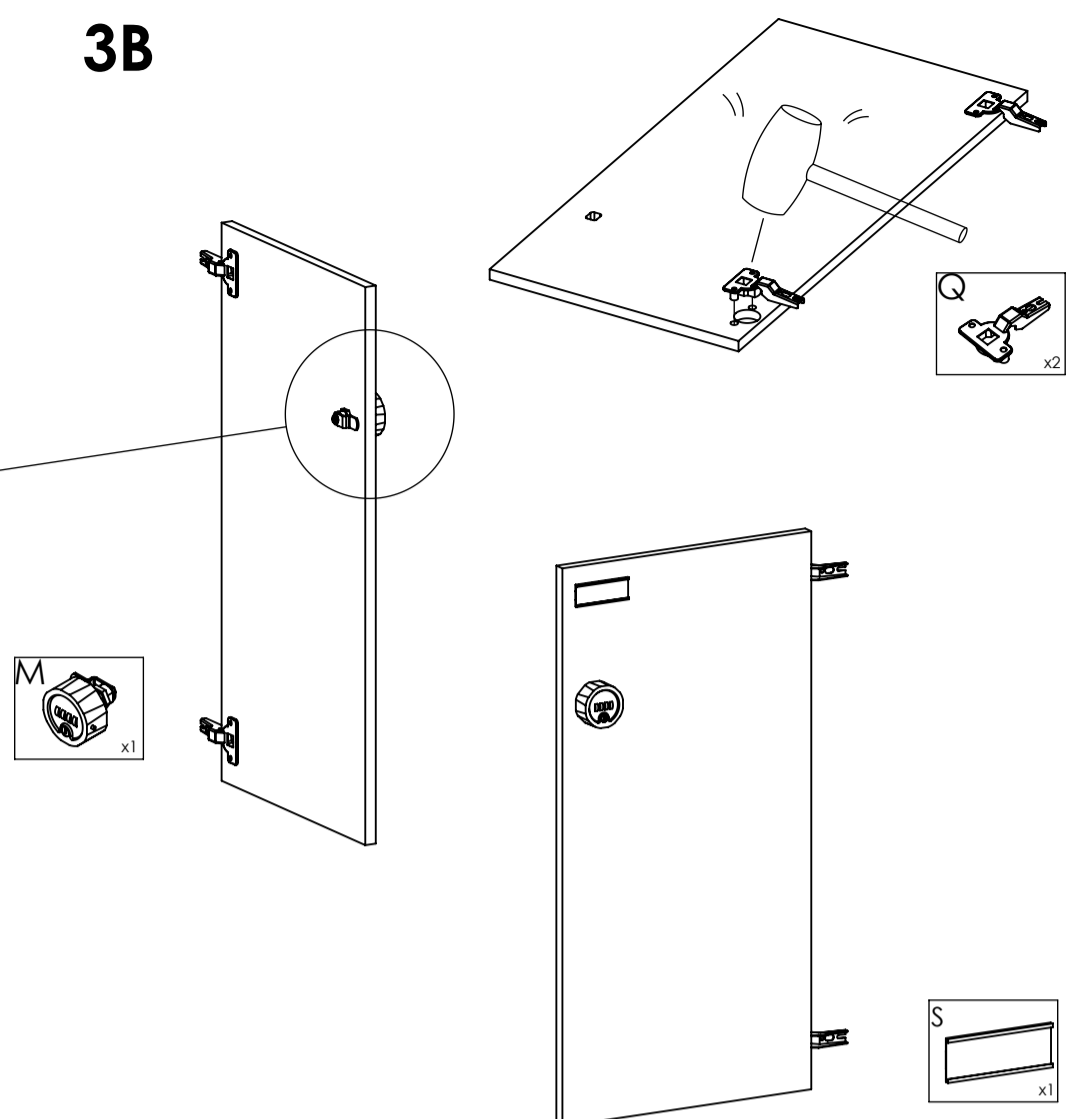

4B

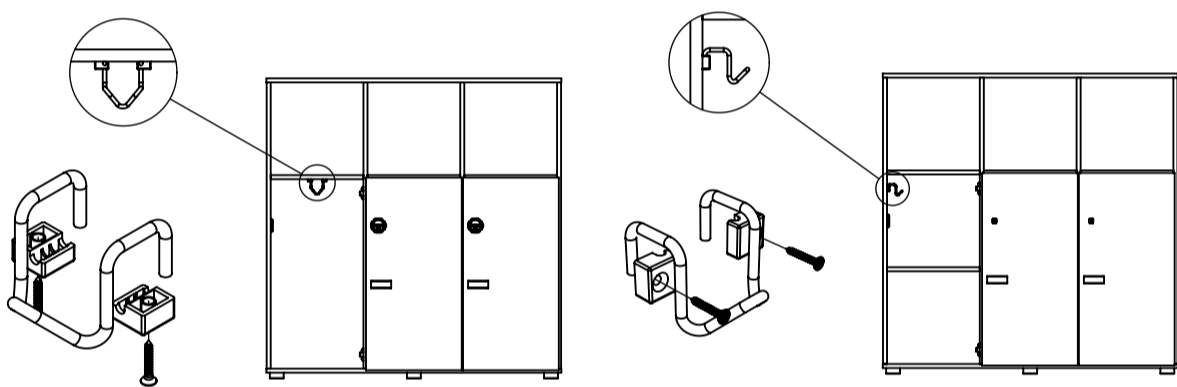

Rep.	Pièce	Qté
U	PATÈRE/Composant FIL INOX Ø5/ Brossage satiné	3
V	Support fil	6
W	Vis TF 3x20	6

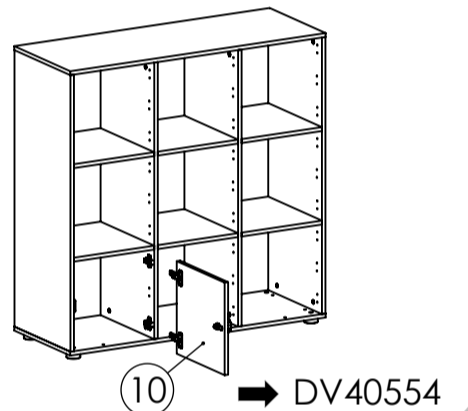
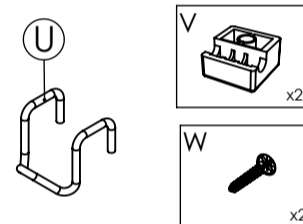

Paramétrage du code / User code setting

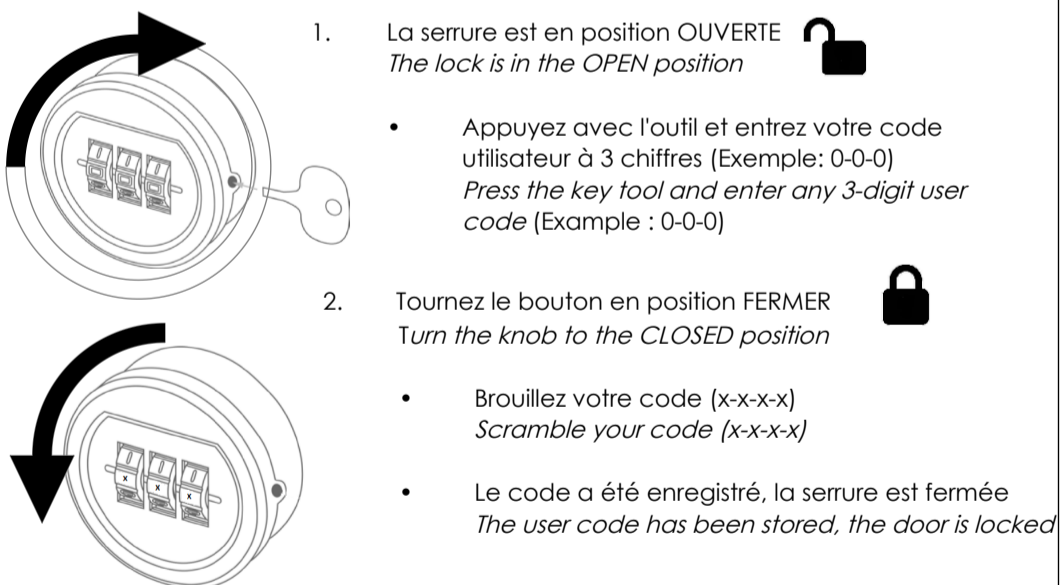

Ouverture / Unlock

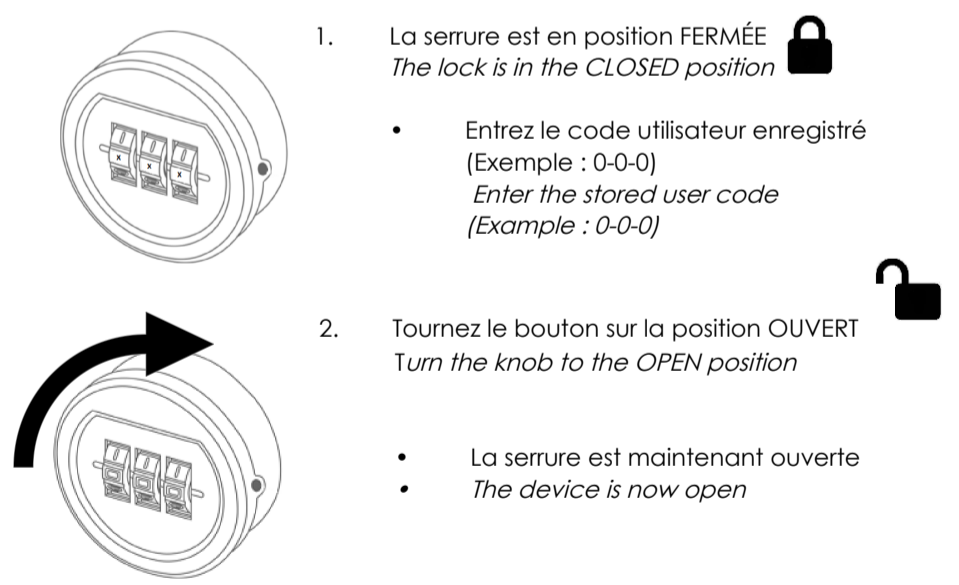

Récupération de code perdu/oublié // Recovering lost / forgotten code

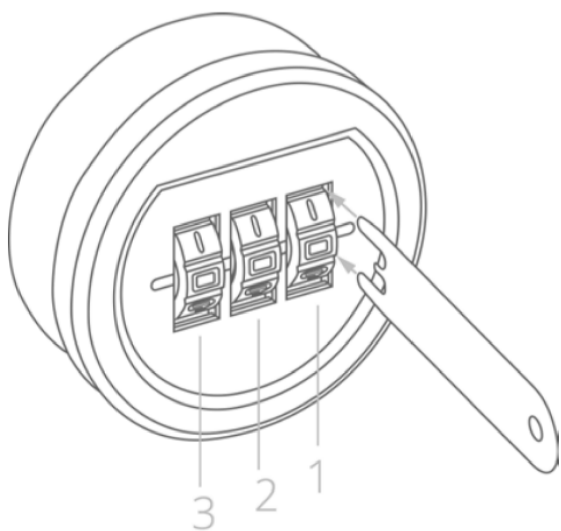

- La serrure est en position FERMÉE
The lock is in the CLOSED position
 - Insérez la clé passe telle que sur l'illustration.
Insert the master key the same way as the illustration.
- Faites défiler le cadran où le passe est inséré vers le bas jusqu'à son blocage.
Scroll the dial next to the key downwards until it stops at a number.
- Répétez l'opération 1 et 2 sur les autres cadrans
Repeat step 1 and 2 to the others dials.
- Tournez le bouton vers la position OUVÈRTE
Turn the knob to the OPEN position
La serrure est prête pour un nouveau code
The lock is ready for a new code.

NOTICE DE MONTAGE
INSTRUCTIONS FOR ASSEMBLY
MONTAGEANLEITUNG
GEBRUIKSAANWIJZING
ISTRUZIONI DI MONTAGGIO
INSTRUCCIONES DE MONTAJE
INSTRUÇÕES DE MONTAGEM

buronomic

FABRICANT FRANÇAIS

N° DV40914

CONCEPTION ET REALISATION BUREAU D'ETUDES BURONOMIC

GARANTIE (vices cachés)
_ Référence produit à nous communiquer impérativement en cas de litige :
Voir étiquette apposée au dos du produit

GARANTIE (defekt)
_ In the event of complaint, it is essential to mention the product reference :
See label affixed to the back of the product.

GARANTIE (fabrikationsfeil)
_ Im streifall sit uns die produktreferenz mitzuteilen :
Siehe etikett auf produktseite.

WAARBORG (de verborgen gebreken)
_ Vermeld in geval van klachten altijd het productnummer :
Zie label op de achterzijde van het product

GARANZIA (vizi oculte)
_ Specificare obbligatoriamente il riferimento prodotto in caso di contestazioni :
Si veda l'etichetta applicata dietro il prodotto

GARANTIA (defectos ocultos)
_ Referencia de producto citese obligatoriamente en caso de reclamacion :
Ver etiqueta en la parte posterior del producto.

GARANTIA (vices ocultas)
_ Em caso de reclamação indiqu-nos imperativamente a referência do produto :
Ver etiqueta fixada na parte posterior do produto

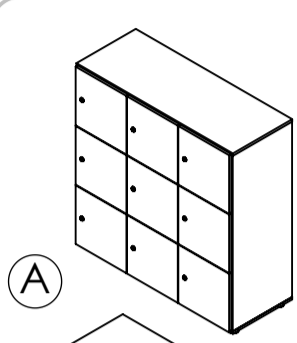

A

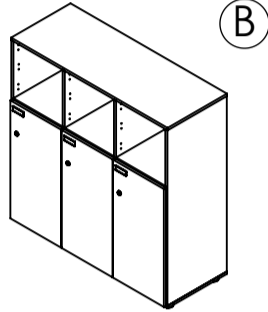
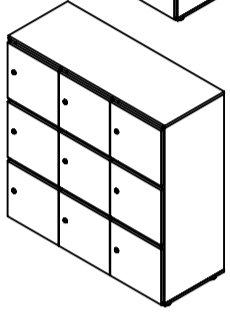

B



6 Mn/Porte

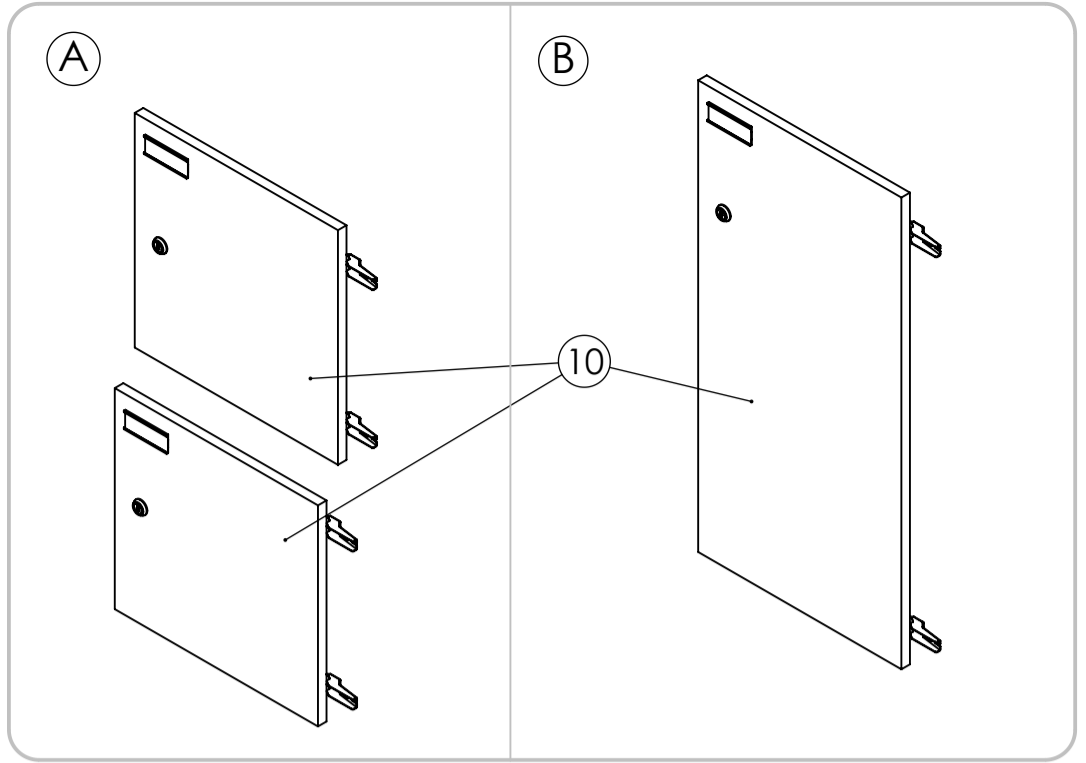
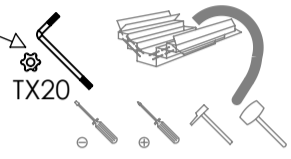

NOMENCLATURE (Parts list)
(Stückliste)
(Onderdelenlijst)
(Nomenclatura)
(Lista de peças)

Rep.	Pièce	Qté
10	PORTE serrure à clé	1

QUINCAILLERIE (Hardware)
(Beschläge)
(Izerwaren)
(Ferramentas)
(Herrajes)
(Quinilharia)

Rep.	Pièce	Qté	M	N	O
M	Serrure à clé	3			
N	GACHE Tôle	3			
O	VIS Euro L 13mm	6			
P	Vis TCB 3x13	3			
Q	Charnière	6			
R	Cale charnière	6			
S	Porte étiquette	3			
			Y	Z	

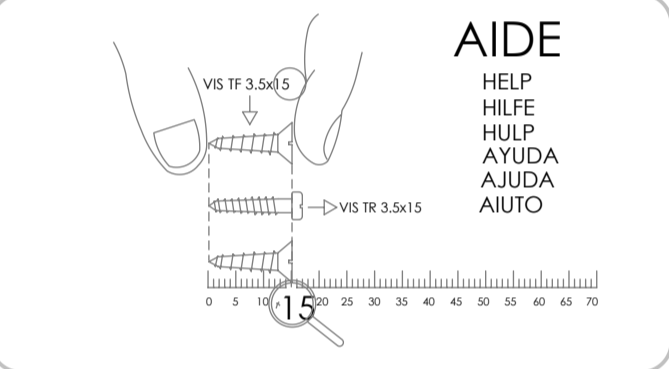

AIDE

HELP
HILFE
HULP
AYUDA
AJUDA
AIUTO

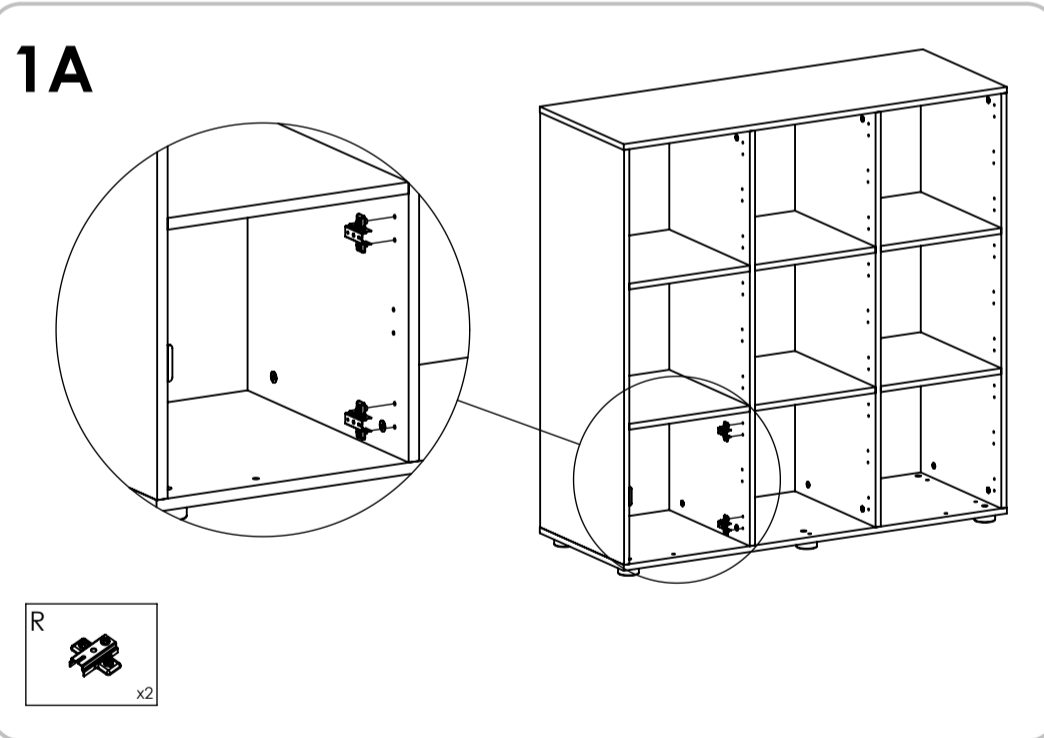
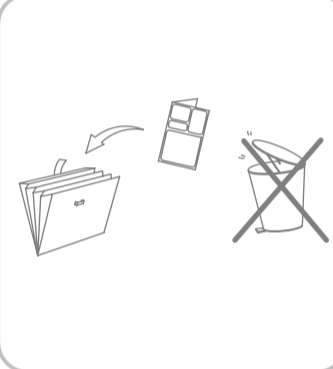

1A

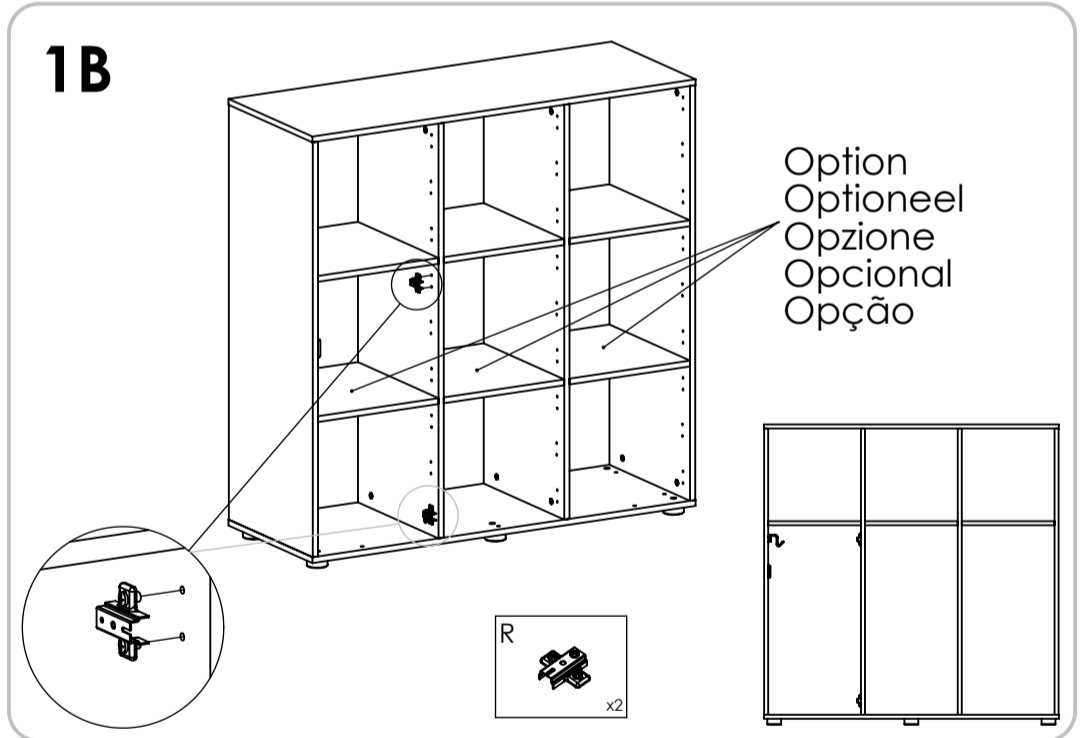
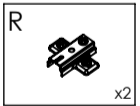

1B

Option
Optioneel
Opzione
Opcional
Opção

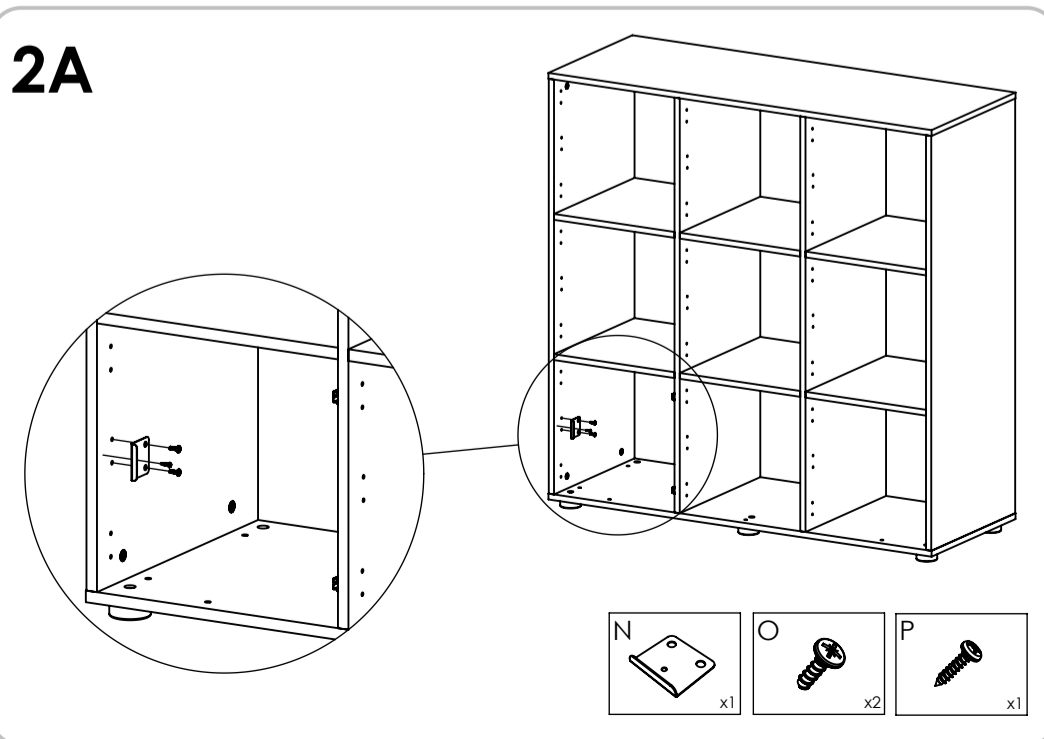
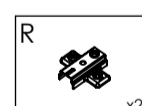

2A

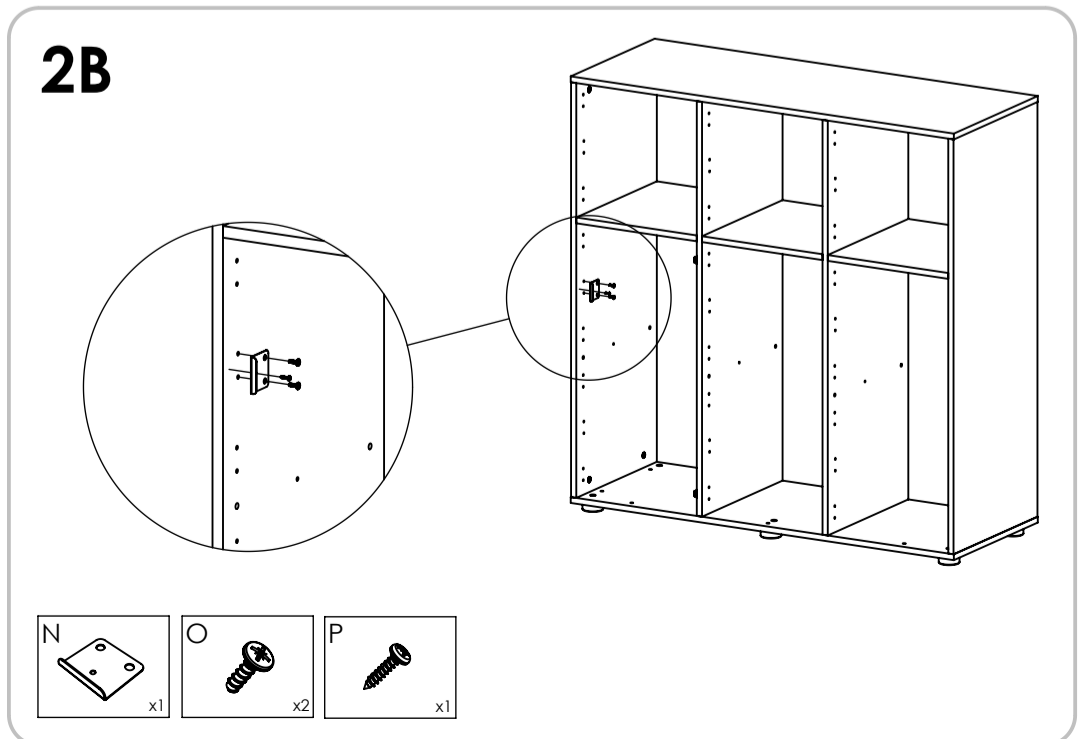
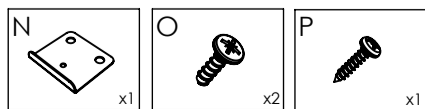

2B

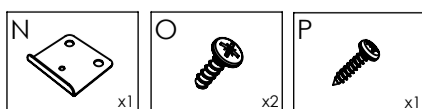

3A

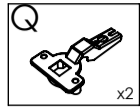
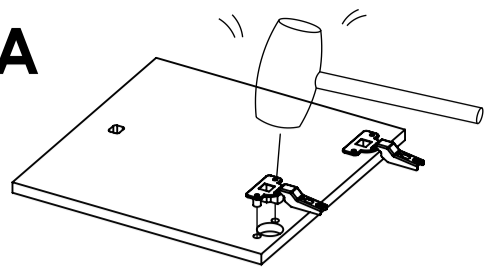

Torx TX20

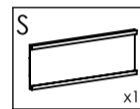
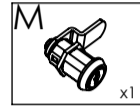
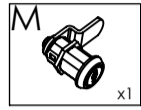
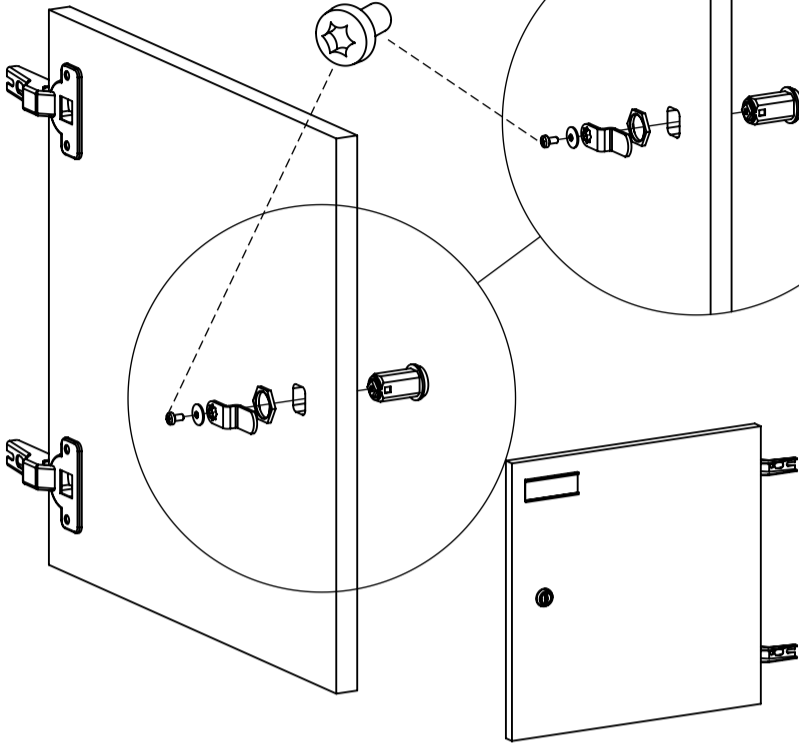

3B

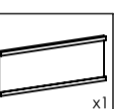
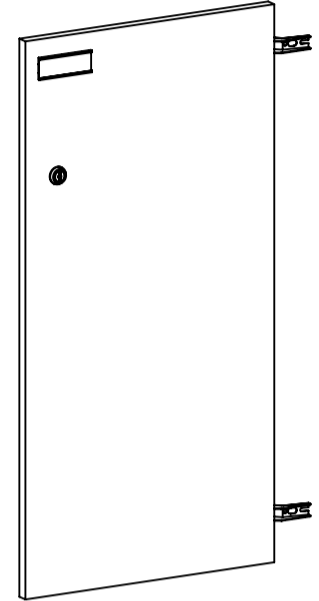
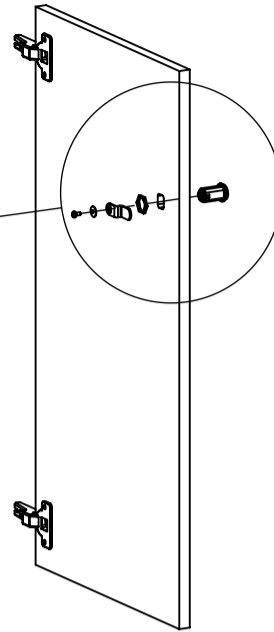
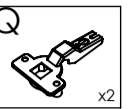
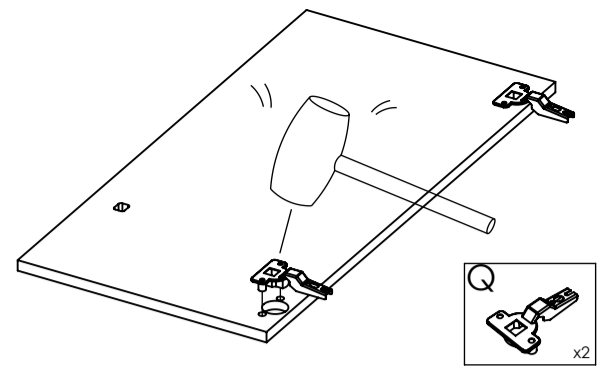

4B

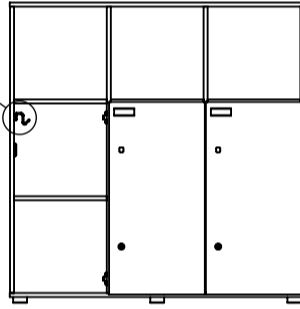
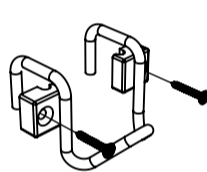
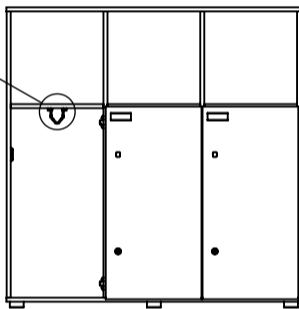
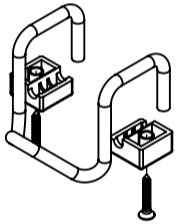
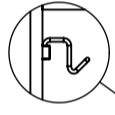
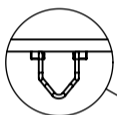

Rep.	Pièce	Qté
U	PATERE/Composant FIL INOX Ø5/ Brossage satiné	3
V	Support fil	6
W	Vis TF 3x20	6

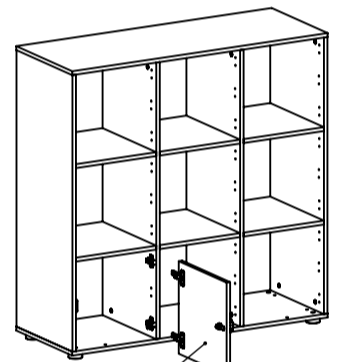
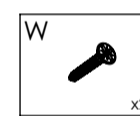
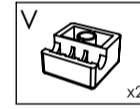
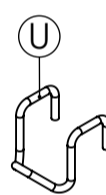

10 → DV40554

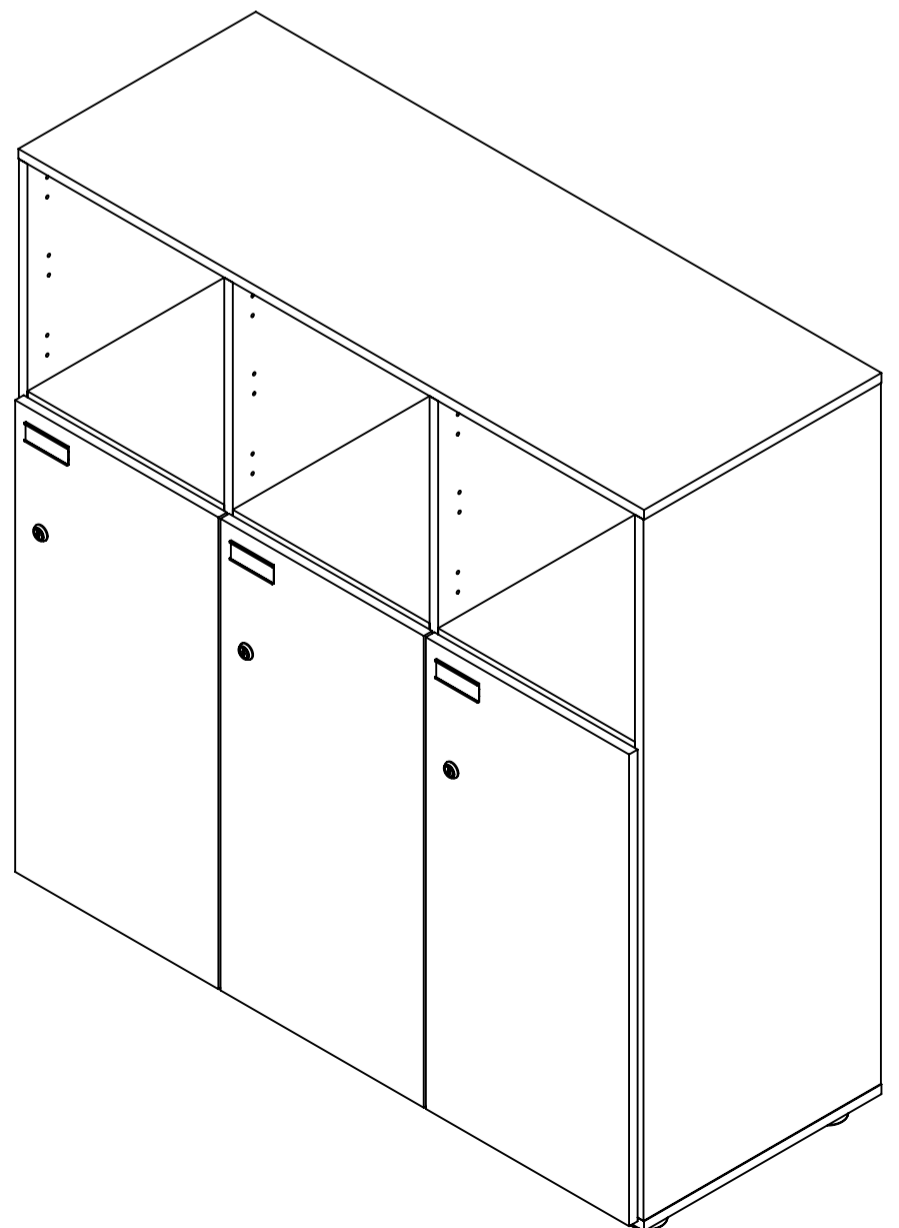
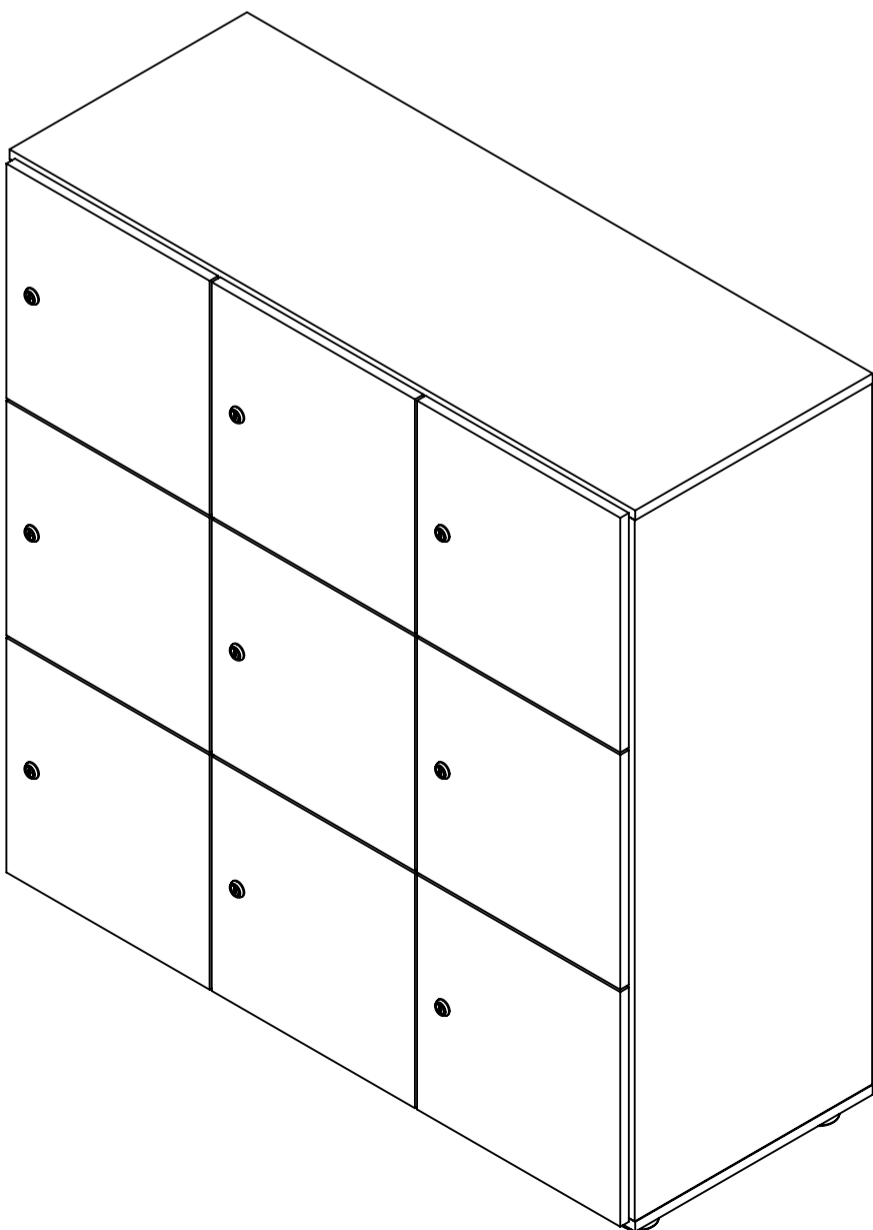

buronomic

FABRICANT FRANÇAIS

N° DV40856

CONCEPTION ET REALISATION BUREAU D'ETUDES BURONOMIC

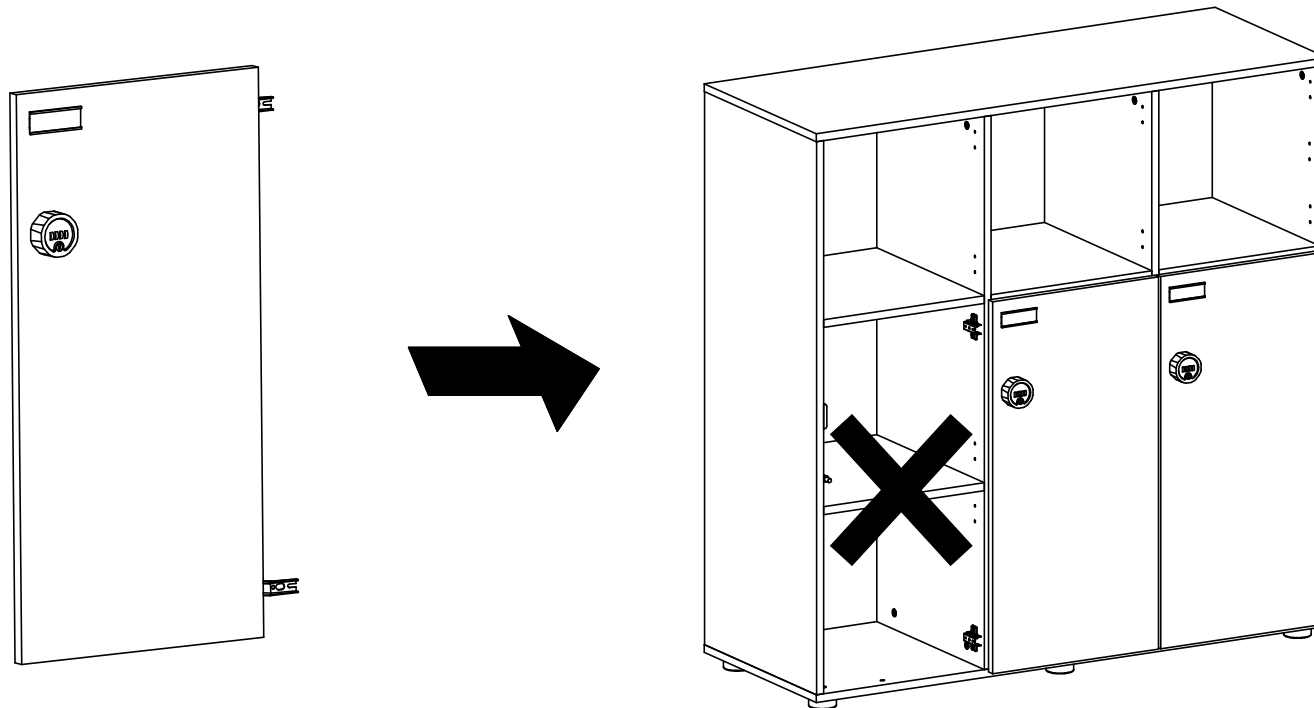
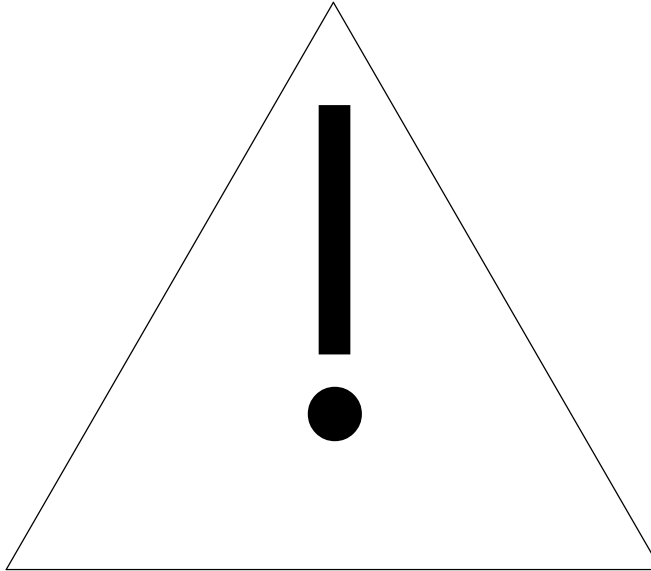

3A

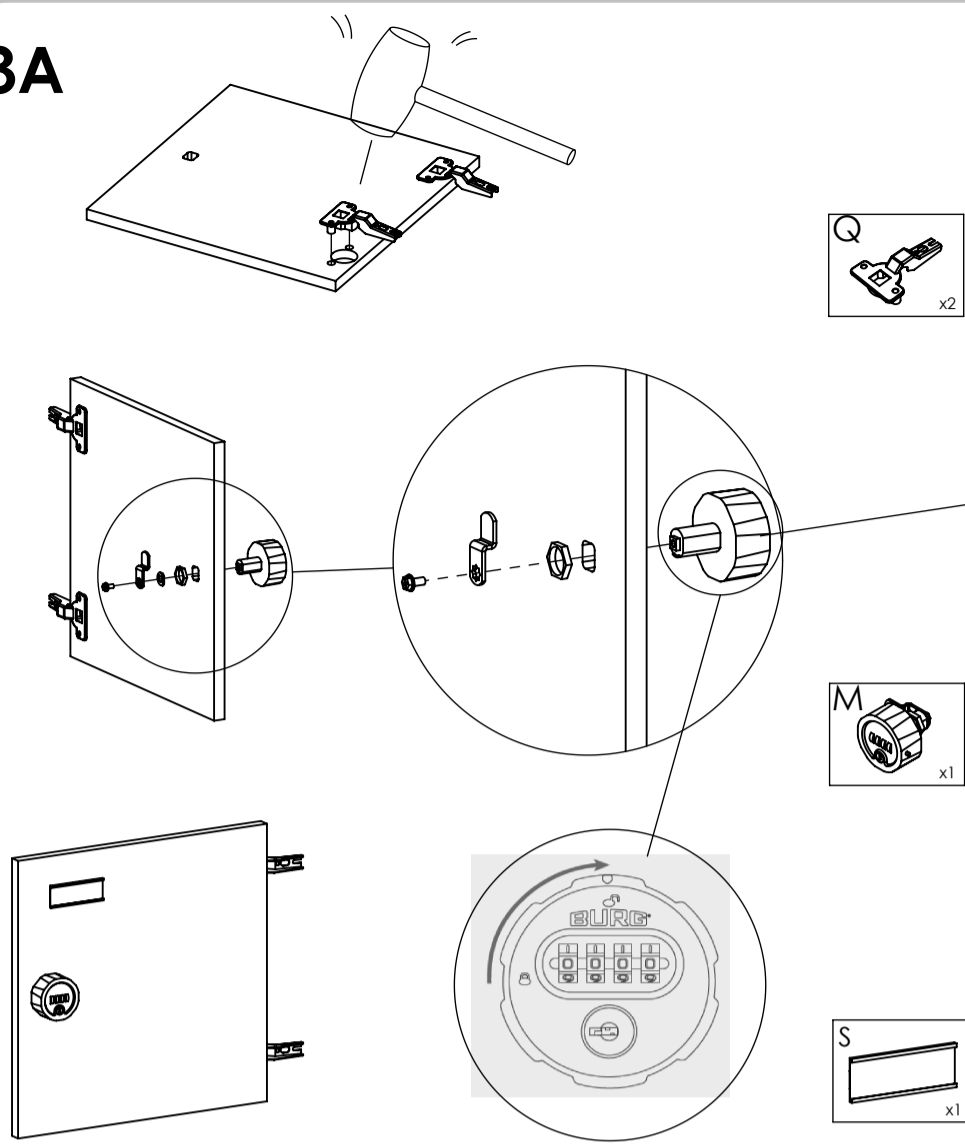

3B

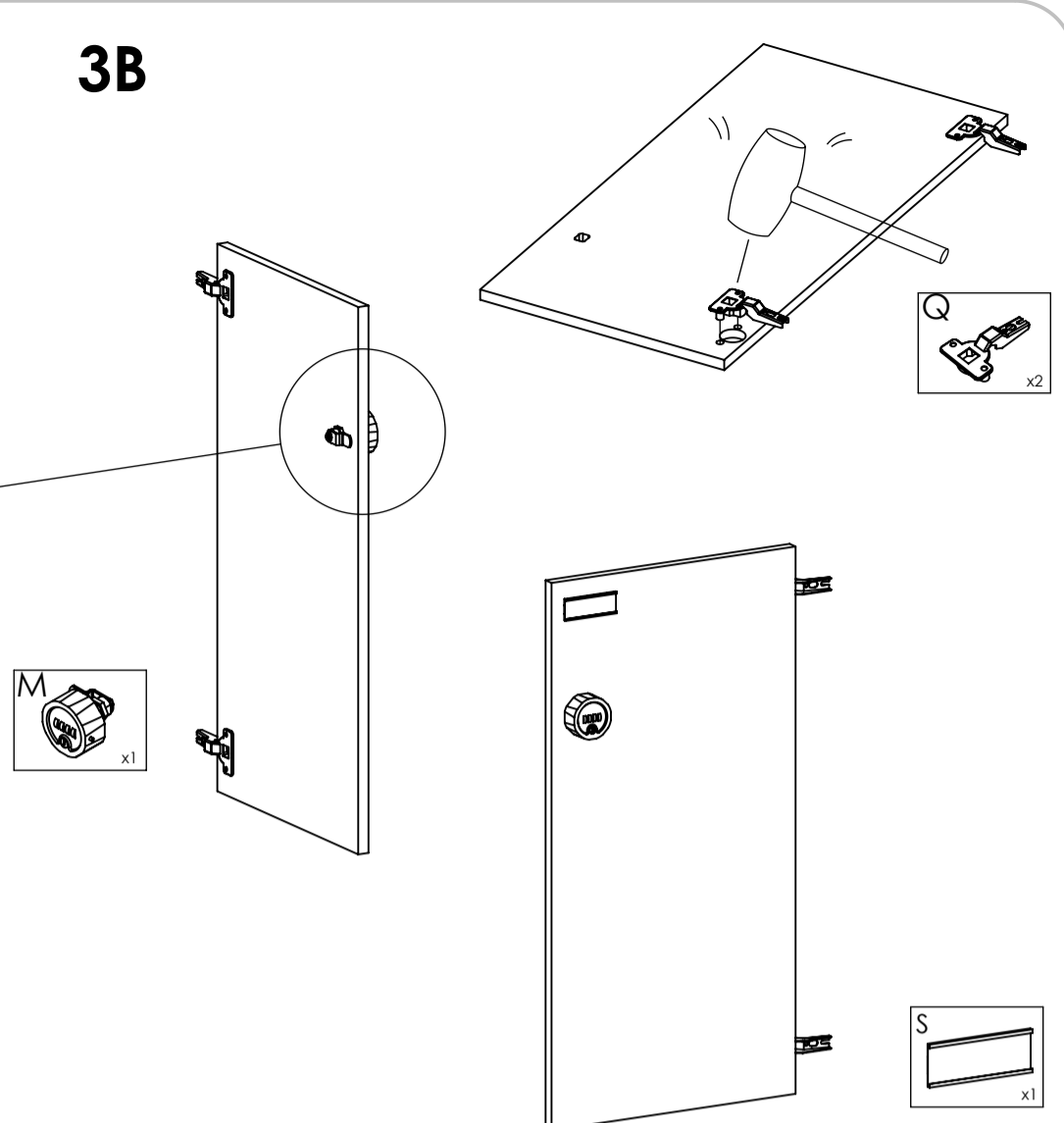

4B

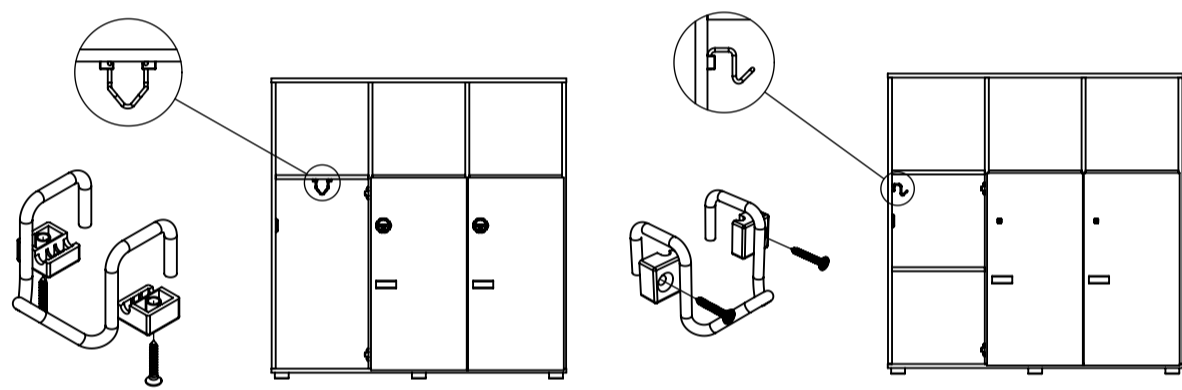

Rep.	Pièce	Qté
U	PATERE/Composant FIL INOX Ø5/ Brossage satiné	3
V	Support fil	6
W	Vis TF 3x20	6

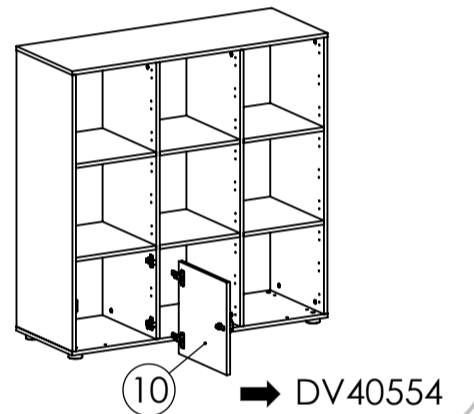
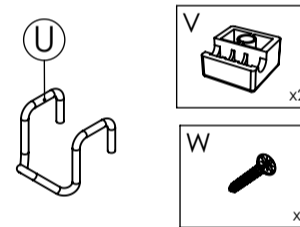

Fermeture / Lock

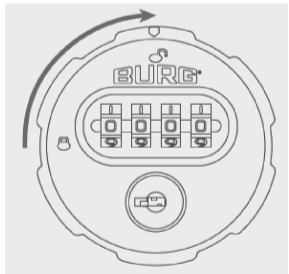

1. La serrure est en position OUVERTE
The lock is in the OPEN position

- Entrez votre à code utilisateur à 4 chiffre
(Exemple: 0-0-0-0)
Enter any 4-digit user code
(Example : 0-0-0-0)

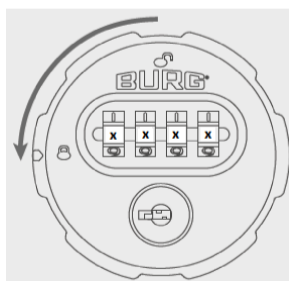

2. Tournez le bouton sur la position FERMER
Turn the knob to the CLOSED position

- Brouillez votre code (x-x-x-x)
Scramble your code (x-x-x-x)
- Le code a été enregistré, la serrure est fermée
The user code has been stored, the door is locked

Ouverture / Unlock

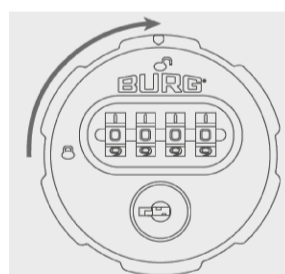

1. La serrure est en position FERMÉE
The lock is in the CLOSED position

- Entrez le code utilisateur enregistré
(Exemple : 0-0-0-0)
Enter the stored user code
(Example : 0-0-0-0)

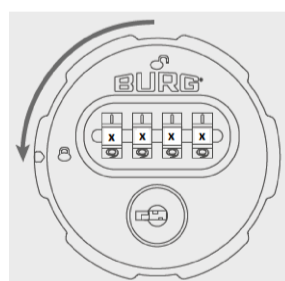

2. Tournez le bouton sur la position OUVERT
Turn the knob to the OPEN position

- La serrure est maintenant ouverte, prête à un nouveau code utilisateur à 4 chiffres.
The device is now open ready for the next user and fresh 4-digit user code.

Récupération de code perdu/oublié // Recovering lost / forgotten code

1. La serrure est en position FERMÉE
The lock is in the CLOSED position

- Insérez la clé et tournez de 90° à droite.
Insert the master key and turn 90° right.

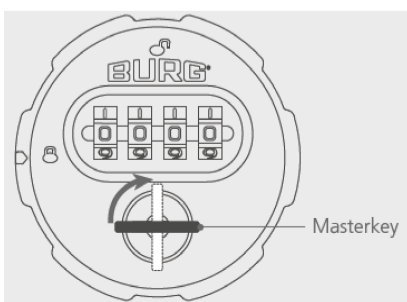

2. Faites défiler chaque cadran vers le bas jusqu'à leur blocage.
Scroll each dial downwards until it stops at a preset number.

- Le code final affiché est le code actuel.
The final code displayed is the current code.

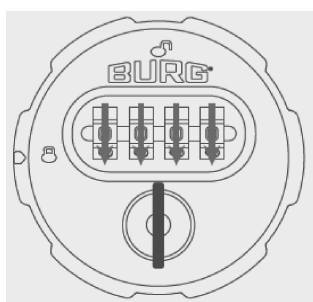

3. Retirez la clé de la serrure.
Remove the key from the lock.

- Tournez le bouton vers la position OUVERTE
Turn the knob to the OPEN position
- La serrure est prête pour un nouveau code
The lock is ready for a new code.

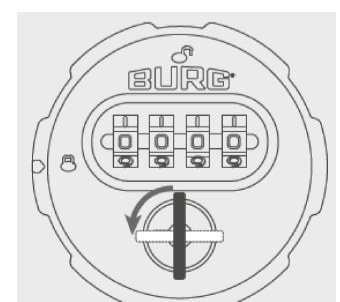

NOTICE DE MONTAGE
INSTRUCTIONS FOR ASSEMBLY
MONTAGEANLEITUNG
GEBRUIKSAANWIJZING
ISTRUZIONI DI MONTAGGIO
INSTRUCCIONES DE MONTAJE
INSTRUCCOES DE MONTAGEM

buronomic

FABRICANT FRANÇAIS

N° DV40896/02

CONCEPTION ET REALISATION BUREAU D'ETUDES BURONOMIC

GARANTIE (vices caches)
_ Référence produit à nous communiquer impérativement en cas de litige :
Voir étiquette apposée au dos du produit

GARANTEE (defekt)
_ In the event of complaint, it is essential to mention the product reference :
See label affixed to the back of the product.

GARANTIE (fabrikationfelher)
_ Im streitfall sit uns die produktreferenz mitzuteilen :
Siehe etikett auf produkdruckseite.

WAARBORG (de verborgen gebreken)
_ Vermeld in geval van klachten altijd het productnummer :
Zie label op de achterzijde van het product

GARANZIA (vizi oculte)
_ Specificare obbligatoriamente il riferimento prodotto in caso di contestazioni :
Si veda l'etichetta applicata dietro il prodotto

GARANTIA (defectos ocultos)
_ Referencia de producto citese obligatoriamente en caso de reclamacion :
Ver etiqueta en la parte posterior del producto.

GARANTIA (vícios ocultos)
_ Em caso de reclamacao indiq-nos imperativamente a referência do produto :
Ver etiqueta fixada na parte posterior do produto

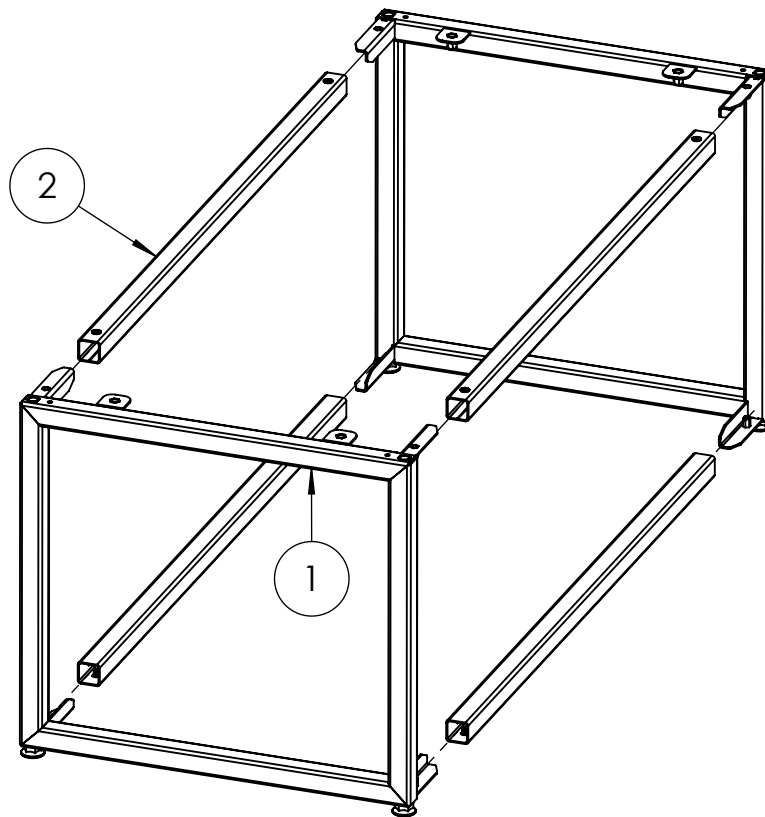
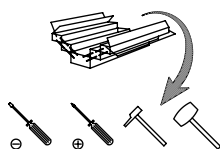
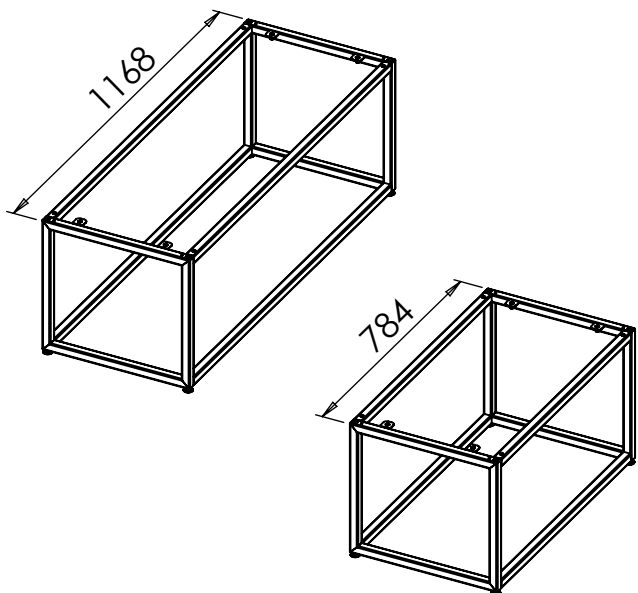

NOMENCLATURE (Parts list)
(Stückliste)
(Onderdelenlijst)
(Nomenclatura)
(Lista de peças)

Rep.	Pièce	Qté
1	CADRE DU SOCLE	2
2	TUBE	4

QUINCAILLERIE

Rep.	Pièce	Qté
A	Vérin Standard	4
B	Vis TFHC 5x10	8
C	Vis TBHC	4
D	Rondelle LU6	4
E	Clé de 3mm	1
F	Clé de 4mm	1

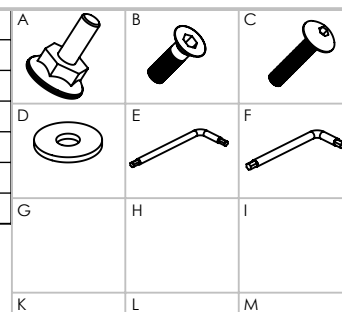

(Hardware)
(Beschläge)
(Ijzerwaren)
(Ferramentas)
(Herrajes)
(Quinquilharia)

AIDE

HELP
HILFE
HULP
AYUDA
AJUDA
AIUTO

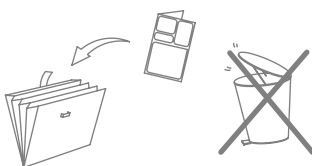
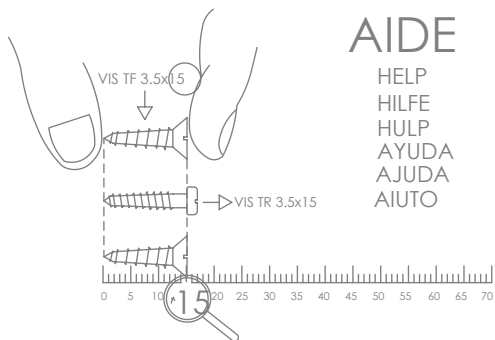

1

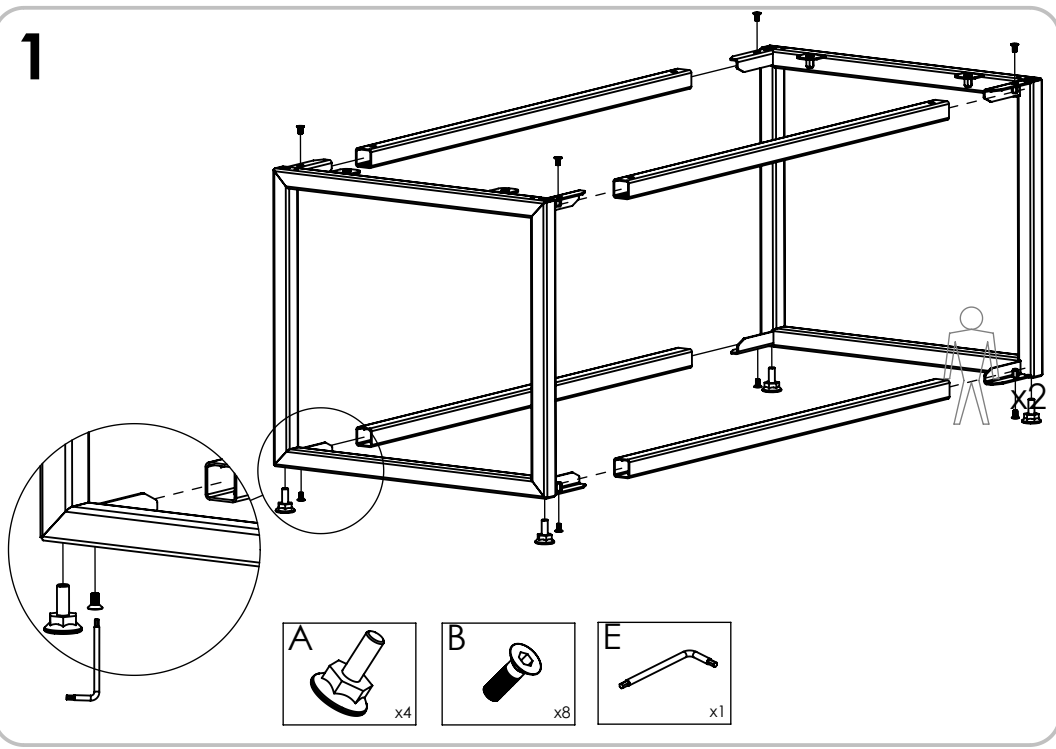

2

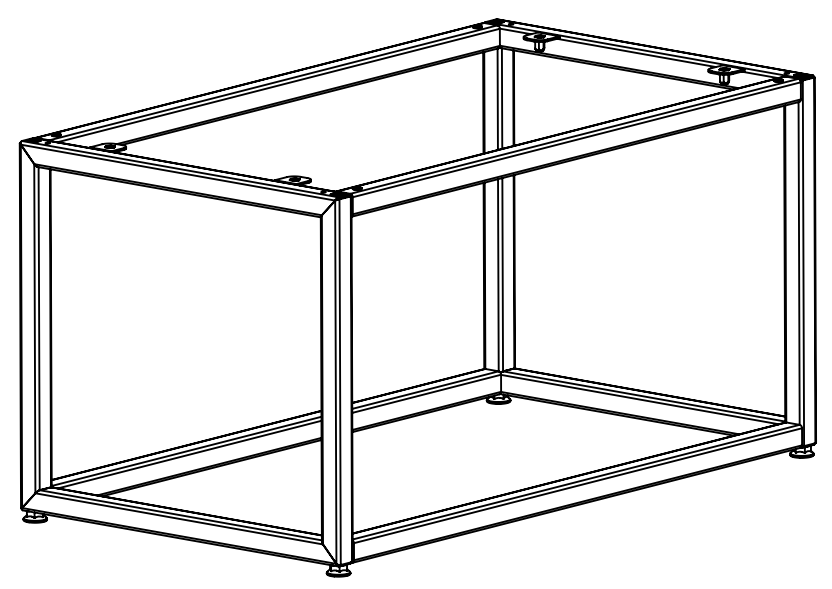

3

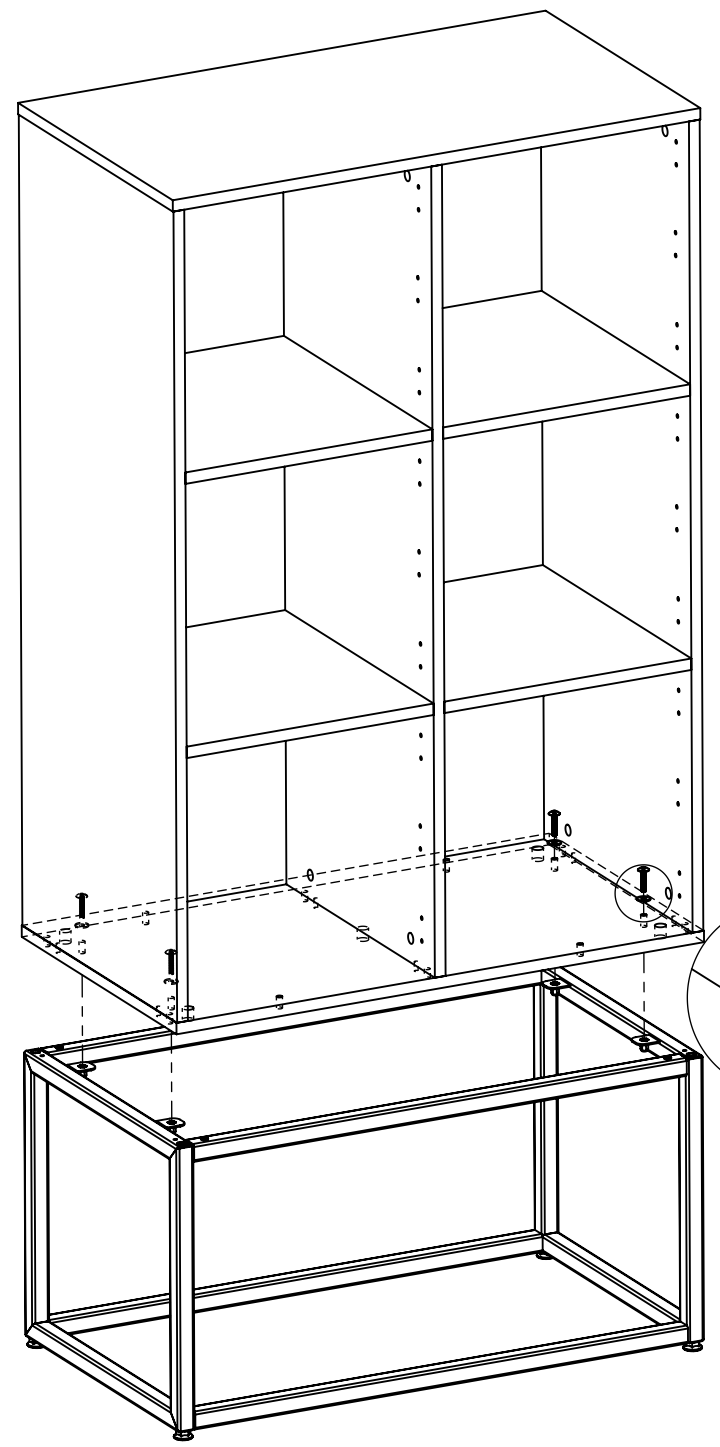

DV40990

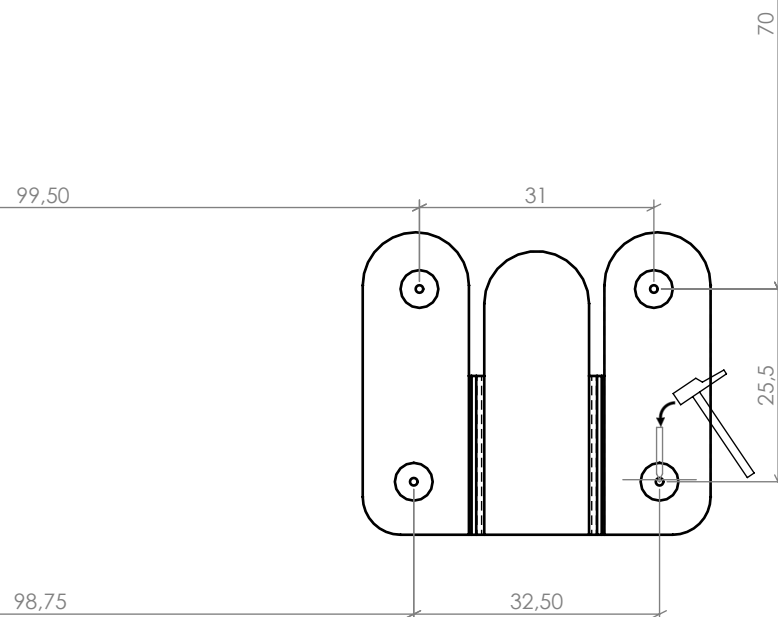

**GABARIT UNIVERSEL COTÉ GAUCHE POUR DOS D'ARMOIRE TAPISSÉ
INSTRUCTION DE POSITIONNEMENT AU VERSO**

*UNIVERSAL UPHOLSTERED BACK WARDROBE LEFT SIDE
POSITIONNING INSTRUCTION ON THE OTHER SIDE*

PLACEMENT POUR GAMME QUIETUDE

POSITIONING FOR "QUIETUDE" RANGE

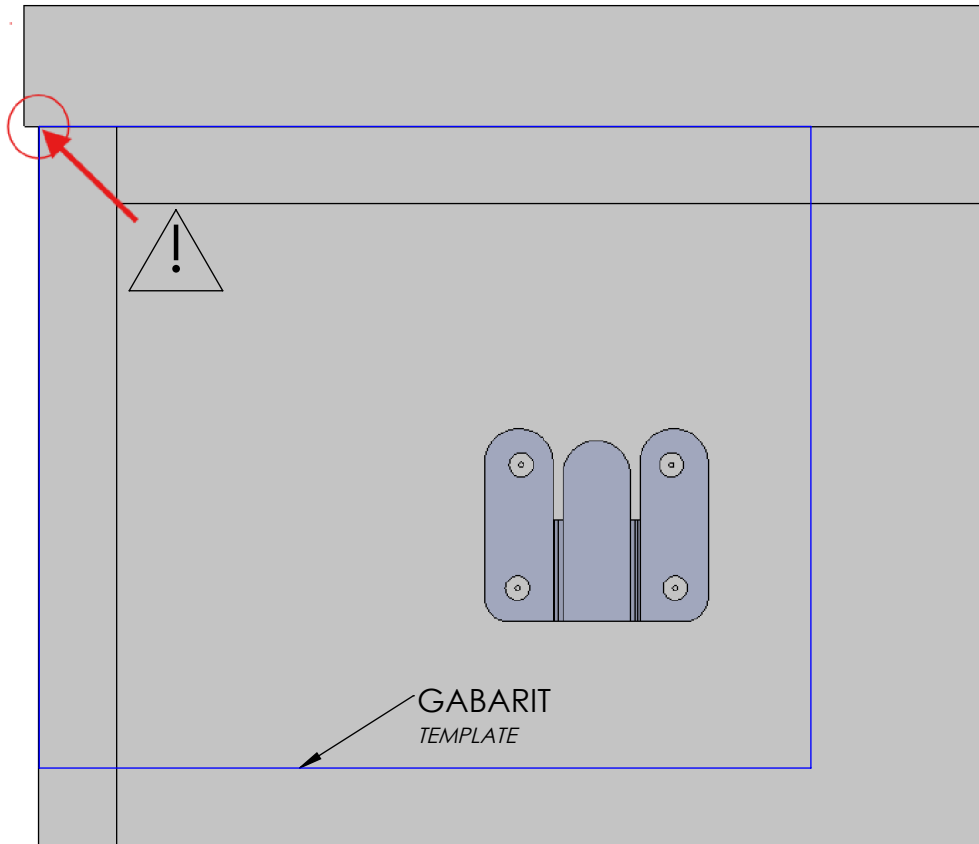
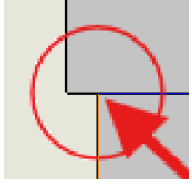

PLACEMENT POUR GAMME EKO

POSITIONING FOR "EKO" RANGE

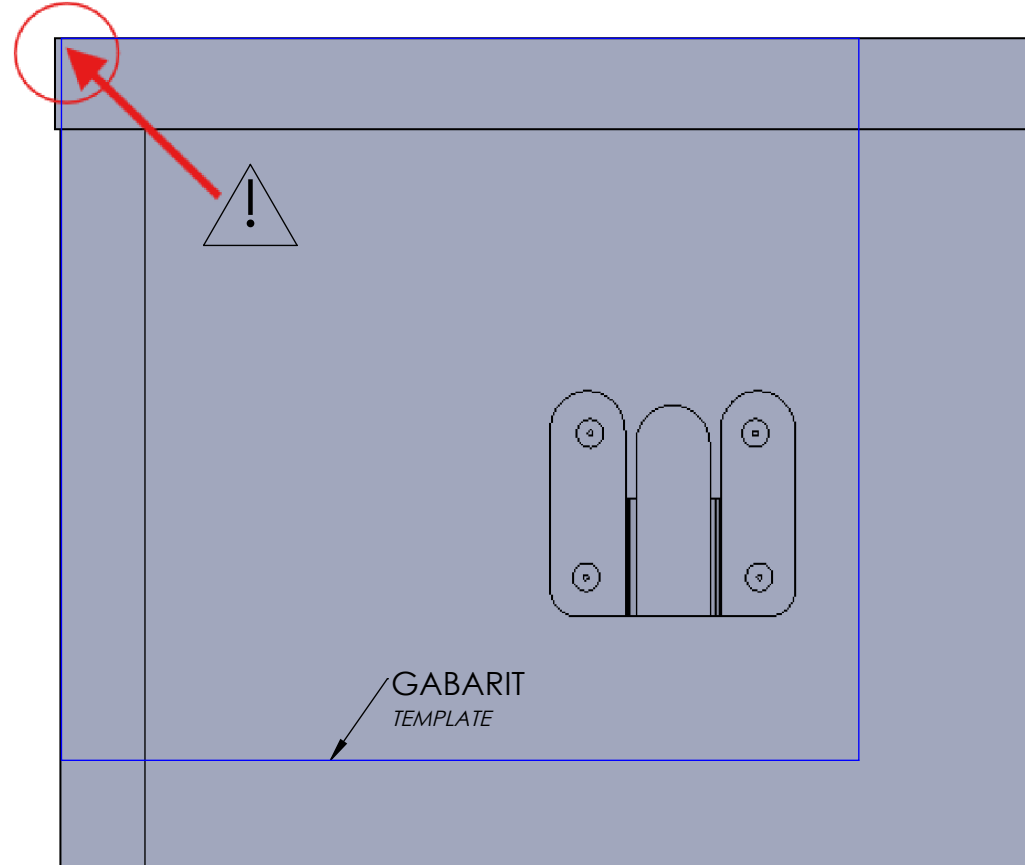
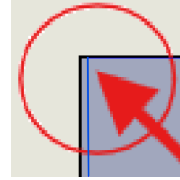

DV40991

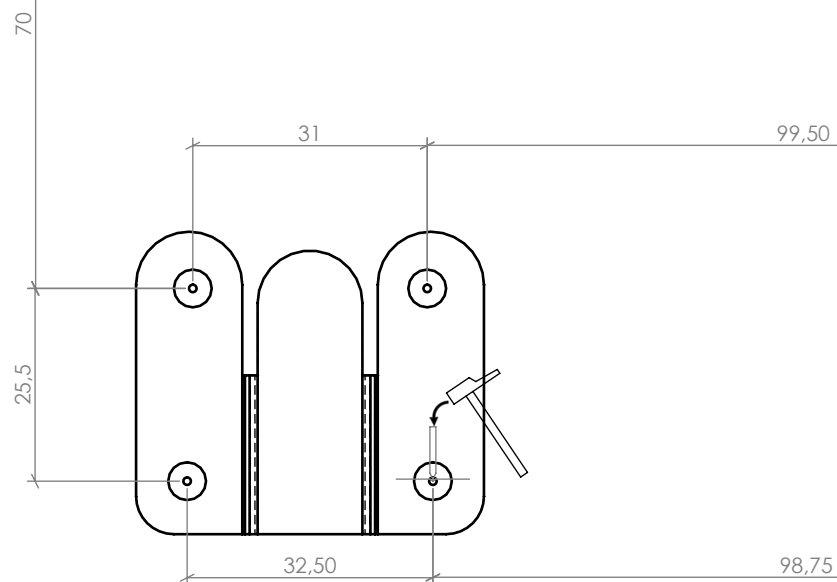

GABARIT UNIVERSEL COTÉ DROIT POUR DOS D'ARMOIRE TAPISSÉ INSTRUCTION DE POSITIONNEMENT AU VERSO

*UNIVERSAL UPHOLSTERED BACK WARDROBE RIGHT SIDE
POSITIONNING INSTRUCTION ON THE OTHER SIDE*

PLACEMENT POUR GAMME QUIETUDE

POSITIONING FOR "QUIETUDE" RANGE

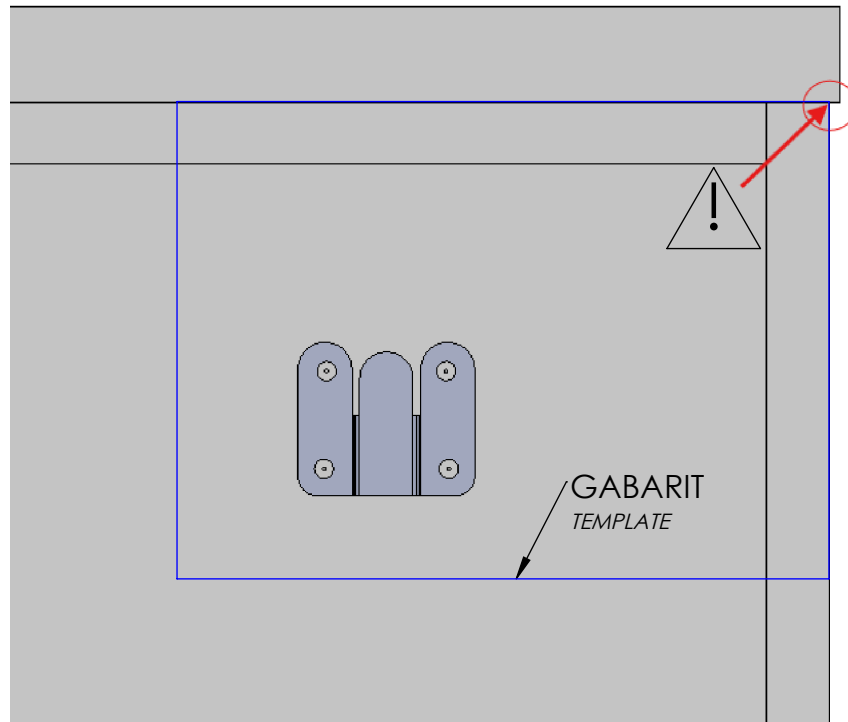
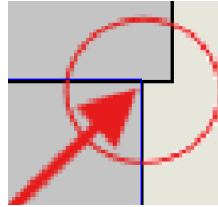

PLACEMENT POUR GAMME EKO

POSITIONING FOR "EKO" RANGE

