

I SOLUTION

Folding tables

Simple and functional, **Solution** folding tables allow you to create single or multiple layouts for multipurpose uses, meetings or training rooms.



CHARACTERISTICS

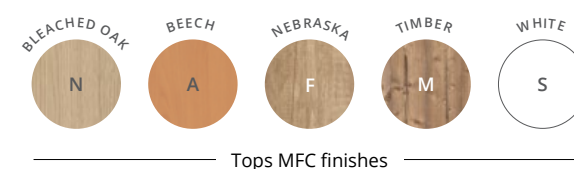
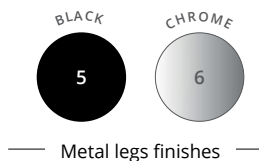

Technical description

- 25 mm thick Structurex® melamine-coated tops with right angles. 2 mm thick shock-proof ABS edging.
- Depth 70 cm to optimise space.
- In folded position the table is only 12 cm thick.
- The "I" metal legs are equipped with adjustable screw feet (range 10 mm) and buffers to protect the tops in folded position.
- The folding mechanism of the legs was selected for easy handling and its secure locking system in open and closed positions.

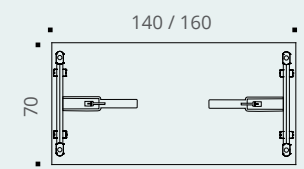

Bottom view

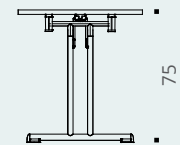

Side view

MEETING



SOLUTION Folding tables



Folding STRAIGHT TABLES

● BLACK LEG

● CHROME LEG

	Dim. (cm)	Ref.	Top finish	Ref.	Top finish
Straight tables D 70 / H 75 cm		DZ145	+ []	DZ146	+ []
		DZ155	+ []	DZ156	+ []
		DZ165	+ []	DZ166	+ []

► Option

Transport cart
for folding tables
Capacity : 10 tables
Payload : 400 kg

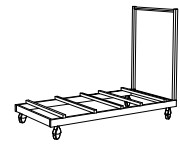

Ref.	Finish
AE635G	Black

Handles to unlock the legs under the tops

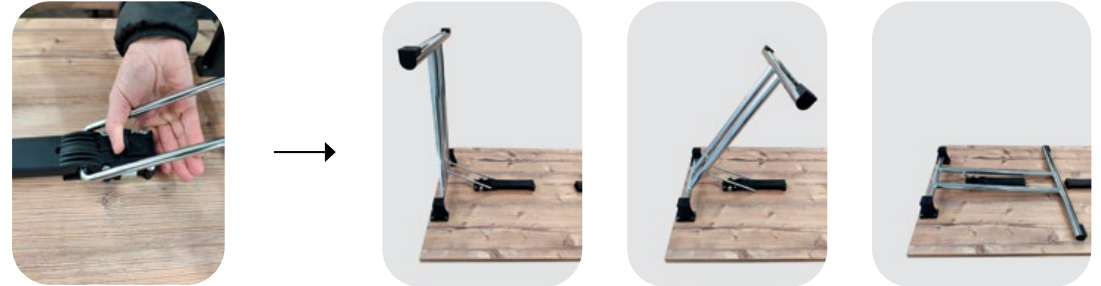

How to order ? L 140 cm folding straight table, Black metal leg, Nebraska top MFC finish = DZ155 + [F]